

NEWTOWN URBAN CONSERVATION STUDY. - 'C' CITATIONS. Ref: 75

Richard Peterson Architect & Conservation Consultant. Daniel Catrice Historian 1996.

NAME: Betta Plumbing Pty Ltd (Glen Pitcher)

PREVIOUS NAME: —

ADDRESS: 288 Latrobe Terrace

USE: House and office.

PREVIOUS USE: House

CONSTRUCTION DATE: c1910? **SOURCE:** Visual.

DESIGNER: — **BUILDER:** —

CRITERIA: H1, Ar1. **HISTORIC THEME:** 2.3

DESCRIPTION: **STYLE:** Edwardian. **STORIES:** 1 **DETACHED.**

MATERIALS: **WALLS** Timber **ROOF** Iron **STRUCTURE** Stud.

CONDITION: Excellent **INTACTNESS:** Excellent. **THREATS:** Traffic

SIGNIFICANT INTACT ELEMENTS:

FORM. FACADE. VERANDAH. ROOF FORM. VERANDAH DECORATION. CHIMNEYS.
WALL DECORATIONS. DOORS. WINDOWS. CONTEXT Nos. 290, 292.

SIGNIFICANCE:

TYPE: HISTORICAL. ARCHITECTURAL.

LEVEL: LOCAL.

DESIGNATION EXISTING: PLANNING SCHEME.

RECOMMENDED CONTROL: PLANNING SCHEME.

GRID REF: **SURVEY:** RP **DATE:** 16.3.96 **NEGS:** 3.32



HISTORY: [*the rate records indicate that a house was built on this allotment in 1874-75. There is no suggestion that a new house was built in Edwardian times. Is it possible that this house was built in the 1870s?*]¹

VISUAL DESCRIPTION: An elevated double-fronted, timber Edwardian house, with a hip roof. Gabled bays project at right and rear side left. Upper gables jetty on ogee brackets in front and quadrant at sides, with Medievalising timbers. Gable windows are oriel bay casements on ogee brackets, with hipped hoods and spectacular quadrant brackets, with tulip motif fretwork decoration (refer: illustration).

The verandah returns around the angle, with a balustrade and palisade valence with Rococo brackets and arcaded panels. At the corner is a splayed, rectangular bay window, with segmental head sashes and leadlight highlights. This projects as a gable, with a horseshoe-shaped valence on decorative brackets. Timber posts have incised mouldings. At left, the verandah terminates at the entry a glazed Edwardian door and sidelight.

SIGNIFICANCE: A timber, substantially Edwardian house, apparently built in 1875 but with substantial additions in about 1910. It is architecturally significant as particularly intact and characteristic of the Edwardian domestic style, with the Art Nouveau influenced horseshoe-shaped valence and organic window-hood brackets. It is historically significant as a representative embodiment of confident family life in Newtown before the Great War.

INTACTNESS: Generally, very good. The entry stair is now re-located to front centre with urns on piers. The fence is also recent and inappropriate.

CONDITION: Excellent. Traffic pollution.

¹ City of Newtown and Chilwell Ratebooks.

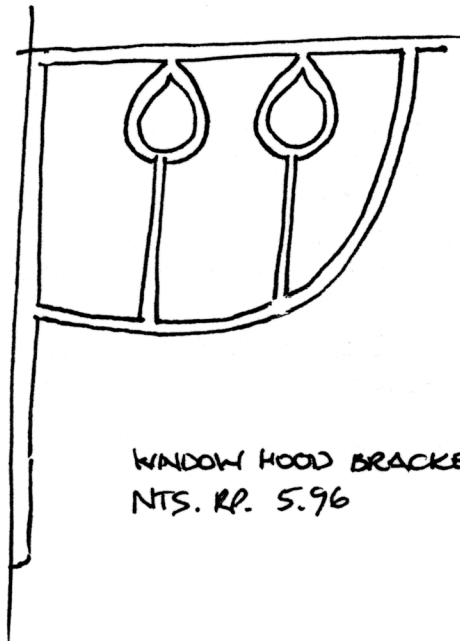
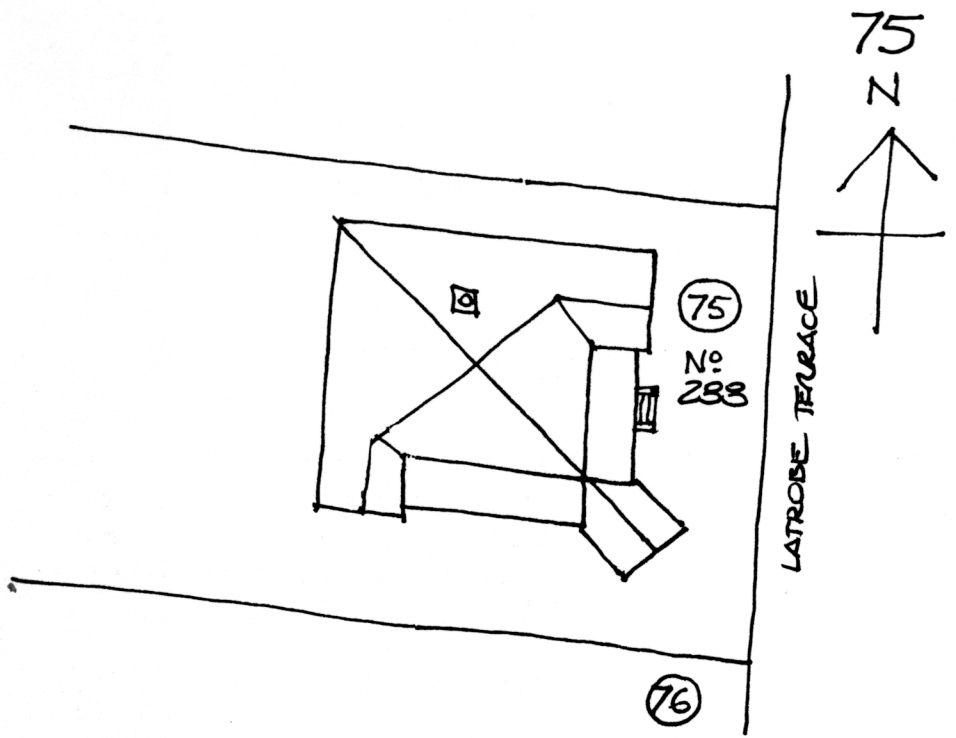

WINDOW HOOD BRACKET DETAIL.
NTS. RP. 5.96