

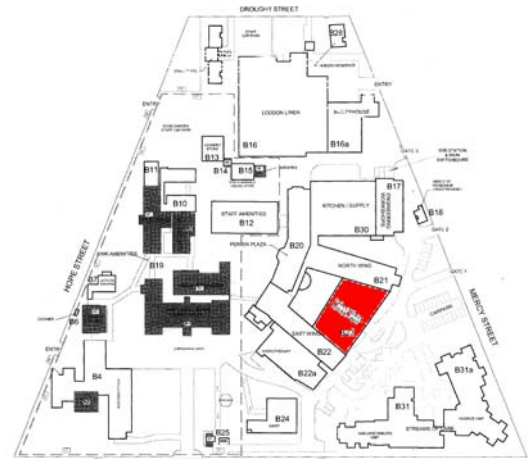

**Location:** Set between the 1958 and 1973 wings.  
**Built:** 1999  
**Date range:**  
**Designer:** Balcombe Griffiths Architect  
**Builder:** Hooker Cockram



**History:**

Dr John Lindell was at one time the hospital Chairman of Committee. The site was originally used for a single storey day hospital constructed in 1966 and then opened by Dr John Lindell. The day hospital was designed to be a place where the elderly were able to go for day treatment of geriatric ailments rather than attending a larger scale (non specific) hospital.

The original day care hospital was constructed as an L shaped building with one leg forming the floor plate of the subsequent North Wing.

The original Day Hospital had examination rooms, a dentist, chiropractor, toilets, consultation rooms an almoner (a chaplain) a gym and a kitchen and dining area.

This new building was opened on 8<sup>th</sup> August 1999 by Rob Knowles MLC Minister for Health.

**Description:**

A three-storey structure in a heavily expressed concrete frame with a porte-cochere addressing the entry area. The building is three times as high as the original day care and has a footprint twice as wide.

The concrete frame is in-filled with a lightweight frame onto which a James Hardies wallboard is attached and lightly rendered.

Windows are large pane in *colorbonded* aluminium sections.

Sunshades are formed from angled metal slats.

**Cultural Heritage Significance**

**Primary Historic Theme:** Development of Bendigo Asylum

No significance

**Historic Sub-Theme:** Post War Development

Of some historical significance in the ongoing use and continuity of naming. Of minimal / indeterminate aesthetic (architectural) significance.



*East Wing and View of the Day Hospital 1970.*