

HAMPDEN ROAD AREA

History and Significance The four allotments bounded by Dandenong Road, Kooyong Road, High Street and Orrong Road was sold at the crown land sale of 15 May, 1850. Five years later when James Kearney compiled his map of Melbourne and suburbs, however, the area was almost totally undeveloped. An exception was a large residence shown on the site of the present day mansion at 50 Hampden Road, and this early building may in fact form part of the present residence.

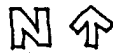

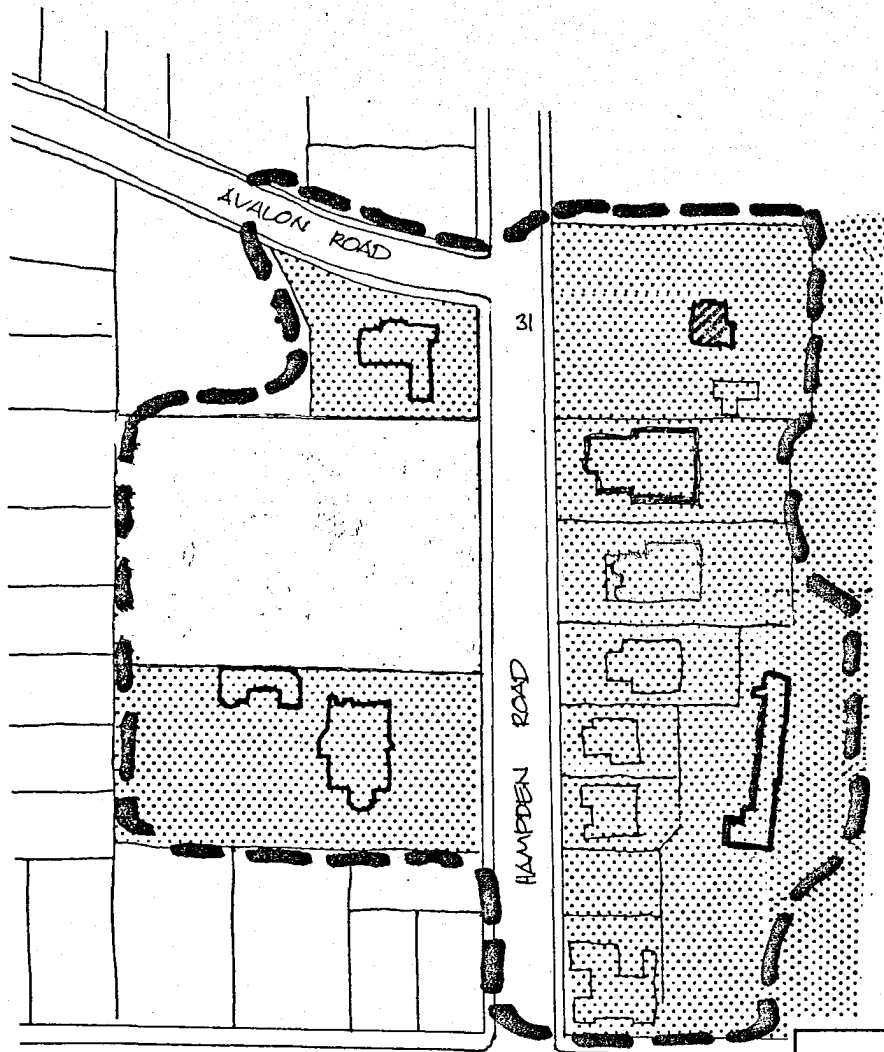





Subdivision since the original land sale has fortunately left several large allotments in the Hampden Road area and today several notable residences are sited on these allotments. The residence at 50 Hampden Road, has had many alterations although the original form of the house is still evident and many early garden features shown on the 1896 Board of Works plan still remain. Next door at 48 Hampden Road a large residence 'Toronto' was erected for the Buxton family in 1922. Opposite at 31 Hampden Road stands the most important residence in the area, designed and occupied (from 1899 to 1906) by eminent Melbourne architect Walter R. Butler from 1899 to 1906. This elegant Edwardian mansion is constructed of red brick with rough cast and cement trimmings with a slate roof. The building is enclosed by a two-storey verandah with ornate turned timber posts and these architectural features are considerably enhanced by the superb garden which is fronted by a timber picket fence and large hedge.

With the construction of an electric tramway along Dandenong Road between Chapel Street and Glenferrie Road, the councils of Prahran, St. Kilda, Malvern and Caulfield co-operated to transform the broad stock route which became Great Dandenong Road into the tree lined boulevard that exists today. Money for these improvements was shared by the councils with the Prahran and Malvern Tramway Trust. With the advent of the tram shortly after the First World War residential flats sprang up along the route and today many of the earlier flats add diversity to the Hampden Road area, contrasting with the larger and earlier residences. The area is also enhanced by its mature street trees, especially the closely planted avenue along Avalon Street to the north of this area.



DANDENONG ROAD

KEY TO MAPS

- A BUILDINGS
- A1 BUILDING 
- A2 BUILDING 
- B BUILDING 
- C BUILDING 
- non identified building 
- A1 AREA 
- A2 AREA 
- combined boundary 

HAMPDEN ROAD AREA