

GREATER GEELONG OUTER AREAS HERITAGE STUDY: STAGE 2

ADMINISTRATIVE SHEET

<p style="text-align: center;">Existing Use/Type</p> <div style="border: 1px solid black; padding: 2px; text-align: center;">Archaeological</div>	<p style="text-align: center;">Key Dates</p> <p>Original 1852c</p> <p>Major Changes 1980s</p>	<p style="text-align: center;">Site Address</p> <p>No. <input style="width: 40px;" type="text" value="5"/> Street/Site Name <input style="width: 150px;" type="text" value="Fyansford-Gheringhap Road"/></p> <p>Town/Suburb <input style="width: 100px;" type="text" value="Fyansford"/> Postcode <input style="width: 60px;" type="text" value="3221"/></p> <p>Current Site Name <input style="width: 150px;" type="text" value="Junction/Keens Hotel Ruins"/></p>
<p>Survey Date <input style="width: 100px;" type="text" value="01/07/1998"/></p> <p>Cons Man Plan <input style="width: 100px;" type="text"/></p>	<p>Precinct Name <input style="width: 100px;" type="text" value="N/A"/></p>	
<p>Recorded By <input style="width: 150px;" type="text" value="D Rowe & L Huddle"/></p>		

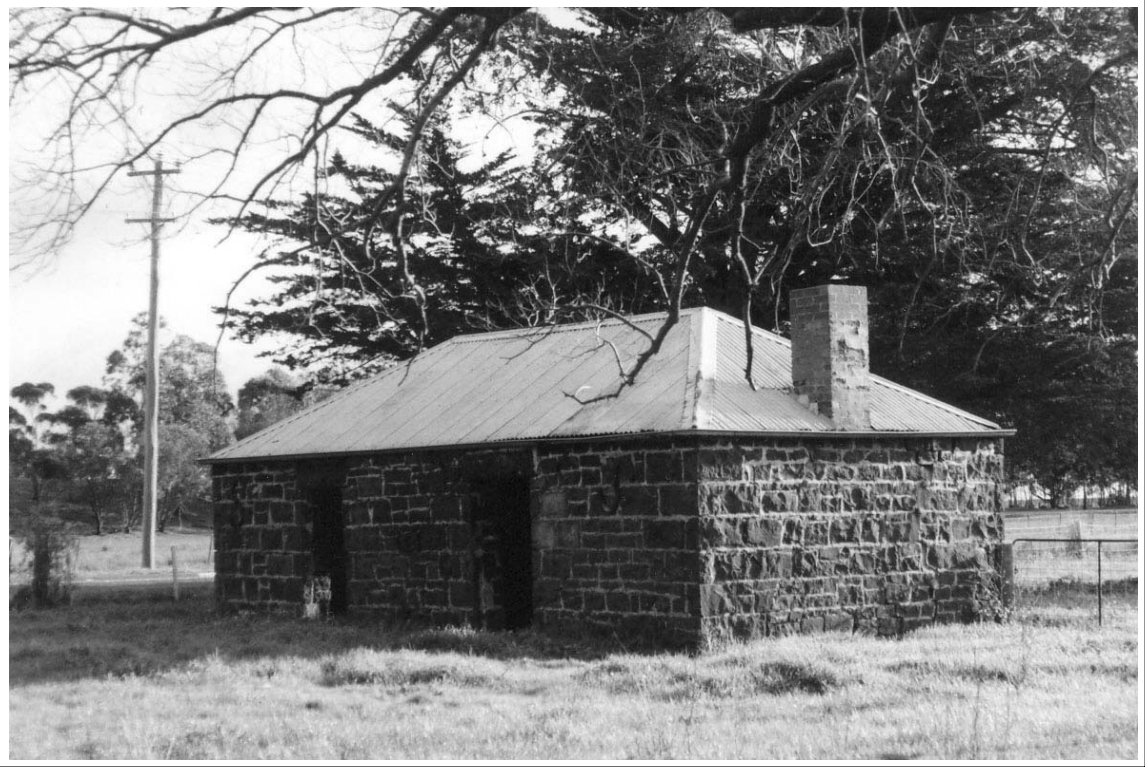

Heritage Status

Register of the National Estate

Database No. File No.

Victorian Heritage Register

Planning Scheme:

Heritage Inventory (Archaeological)

National Trust Register:

Other:

Recommended Heritage Listings

Victorian Heritage Register
 Victorian Heritage Inventory
 Register of the National Estate
 HO City of Greater Geelong

Heritage Study Degrees of Significance

A H C Assessment Criteria	Significance Level
Aesthetic value <input style="width: 100px;" type="text"/>	<input style="width: 100px;" type="text"/>
Historic value <input style="width: 100px;" type="text" value="A 4"/>	<input style="width: 100px;" type="text" value="Local"/>
Scientific value <input style="width: 100px;" type="text" value="F 1"/>	<input style="width: 100px;" type="text" value="Local"/>
Social value <input style="width: 100px;" type="text"/>	<input style="width: 100px;" type="text"/>
Overall Significance Level	<input style="width: 100px;" type="text" value="Local"/>

Condition of the fabric

Excellent
 Good
 Fair
 Poor
 Ruinous
 Unexposed

Integrity of the site

Excellent
 Good
 Fair
 Poor
 Partially excavated
 Fully excavated

PAGE 1 of 4

GREATER GEELONG OUTER AREAS HERITAGE STUDY: STAGE 2

TECHNICAL SHEET

Precinct Name <input style="width: 150px;" type="text" value="N/A"/> Site Plan/Location Sketch (not to scale) 	<div style="text-align: center;">Site Address</div> No. <input style="width: 30px;" type="text" value="5"/> Street/Site Name <input style="width: 150px;" type="text" value="Fyansford-Gheringhap Road"/> Town/Suburb <input style="width: 100px;" type="text" value="Fyansford"/> Postcode <input style="width: 50px;" type="text" value="3221"/> Site Name <input style="width: 150px;" type="text" value="Junction/Keens Hotel Ruins"/> <div style="text-align: center;">Australian Map Grid Co-ordinates</div> E 262250km N 5775200km Map <input style="width: 100px;" type="text" value="Geelong 7721-1-3"/> Scale <input style="width: 100px;" type="text" value="1:25,000"/> Ownership <input style="width: 150px;" type="text" value="Private"/> <div style="text-align: center;">Cadastral Location</div> County <input style="width: 100px;" type="text" value="Grant"/> Parish <input style="width: 100px;" type="text" value="Gheringhap"/> Allotment <input style="width: 100px;" type="text"/> Block <input style="width: 100px;" type="text"/>
--	--

Types of Sites

- | | | | | | | |
|---------------------------------------|---------------------------------------|---|--|----------------------------------|------------------------------------|--|
| <input type="checkbox"/> monument | <input type="checkbox"/> recreational | <input type="checkbox"/> residential | <input type="checkbox"/> aviation | <input type="checkbox"/> gate | <input type="checkbox"/> landscape | <input type="checkbox"/> building |
| <input type="checkbox"/> industrial | <input type="checkbox"/> public | <input type="checkbox"/> infrastructure | <input checked="" type="checkbox"/> relic/ruin | <input type="checkbox"/> tree(s) | <input type="checkbox"/> religious | <input type="checkbox"/> educational |
| <input type="checkbox"/> agricultural | <input type="checkbox"/> commercial | <input type="checkbox"/> maritime | <input type="checkbox"/> fence | <input type="checkbox"/> garden | <input type="checkbox"/> machinery | <input type="checkbox"/> miscellaneous |

Historical Themes

Heritage Study Theme	AHC Theme No.	Heritage Study Theme	AHC Theme No.
Early settlement	<input style="width: 50px;" type="text" value="esInns/Hotels"/>	Industry	<input style="width: 50px;" type="text"/>
Maritime	<input style="width: 50px;" type="text"/>	Community Life	<input style="width: 50px;" type="text" value="clHotels"/>
Tourism	<input style="width: 50px;" type="text"/>	Urbanization	<input style="width: 50px;" type="text"/>
Transport	<input style="width: 50px;" type="text"/>	Landscapes	<input style="width: 50px;" type="text" value="lpsRural"/>
Townships	<input style="width: 50px;" type="text"/>	Miscellaneous	<input style="width: 50px;" type="text"/>

Significant Architectural Features

- Original Materials
- Original Chimneys
- Wall Decoration
- Verandah Structure
- Verandah Decoration
- Original Parapet
- Other Prominent Elevations
- Appropriate Fence
- Early Garden

Roof	<input style="width: 150px;" type="text" value="Form"/>
Openings	<input style="width: 150px;" type="text"/>
Decoration	<input style="width: 150px;" type="text"/>
Finish	<input style="width: 150px;" type="text" value="Unpainted"/>
Stylistic Character	<input style="width: 150px;" type="text" value="Victorian Vernacular"/>

Present Threats

- Human; mining
- Human; visitor erosion
- Human; vandalism
- Human; development
- Human; conservation/maintenance
- Human; stock
- Natural Forces; erosion
- Natural Forces; vegetation
- Not threatened

PAGE 2 of 4

GREATER GEELONG OUTER AREAS HERITAGE STUDY: STAGE 2

Site Address	No.	Street/Site Name	Town/Suburb	Postcode
	5	Fyansford-Gheringhap Road	Fyansford	3221
		Site Name Junction/Keens Hotel Ruins		
Description				
<p>This Victorian Vernacular styled building has a rectangular plan form and is constructed of coursed random rubble bluestone walls and a hipped corrugated iron roof. There is a brick chimney at one end which protrudes through the roof and is visible only above the spouting. There are window and door openings but the doors and windows have been removed.</p> <p>Bluestone footings of a larger building are believed to be extant on the site. (See the History.)</p> <p>There are several mature trees surrounding the site.</p>				
History				
<p>By 1854 a wooden bridge was built across the Moorabool River and there were eight hotels to accommodate the needs of the gold rush travellers. One of these was at the junction of Highway (to Inverleigh) and Gheringhap Road (to Ballarat).³ According to Beaurepaire, "The hotel was a single storey weatherboard building on stone foundations and operated by Mrs Wensor and later by that lady and her new husband, Charles Kean. ... The Junction Hotel was delicensed in 1921 and became a private residence in 1980, when it was demolished to make way for a modern house owned by Mr and Mrs Beck. ... The ruins of a stone shed in recognisable shape and some signs of the floor slab of the hotel are all that remain today."⁴ It was owned and occupied by Charles Keen, publican, and known as the Junction Hotel from at least 1876, and remained in the Keen family ownership until at least 1945. From about 1900 it was occupied by Robert John Tyers, Frederick W Gugger and Matilda ad Charles Cork , in that order.¹ It was variously known as Keens or the Junction Hotel on early maps of the area.</p>				
Heritage Precinct: Significant Urban Character Features visually connected to this place <i>(this section is only applicable to places in precincts)</i>				
				Precinct Name N/A
Neighbouring Buildings	<input type="checkbox"/> Similar Types <input type="checkbox"/> Appropriate Bulk/Form <input type="checkbox"/> Similar Styles <input type="checkbox"/> Appropriate Architectural Detailing <input type="checkbox"/> Similar Construction Dates <input type="checkbox"/> Appropriate Materials & Finishes <input type="checkbox"/> Appropriate Set Backs <input type="checkbox"/> Appropriate Fence Designs & Locations			
	Urban Design	<input type="checkbox"/> Significant Historical Development <input type="checkbox"/> Original Paving <input type="checkbox"/> Significant Urban Focii <input type="checkbox"/> Appropriate Allotment Sizes <input type="checkbox"/> Significant Views <input type="checkbox"/> Appropriate Street Furniture <input type="checkbox"/> Original Kerbing		
Landscaping	<input type="checkbox"/> Treelines <input type="checkbox"/> Public Gardens <input type="checkbox"/> Median Strips <input type="checkbox"/> Nature Strips			

C
O
N
T
E
X
T
U
A
L

S
H
E
E
T

P
A
G
E

3
o
f
4

GREATER GEELONG OUTER AREAS HERITAGE STUDY: STAGE 2

SIGNIFICANCE SHEET

Site Address	No.	Street/Site Name	Town/Suburb	Postcode
	5	Fyansford-Gheringhap Road	Fyansford	3221
			Site Name	Junction/Keens Hotel Ruins

Comparative Listings

Statement of Cultural Significance

The ruins of the Junction Hotel (outbuildings and hotel footings) are **scientifically significant** at a **Local level** for their potential to yield evidence of the lifestyle at one of the earliest hotels established at Fyansford during the gold rush period.

It is **historically significant** at a **Local level** for its association with many early Fyansford farming families, and the evolution of developments in the broader community. It is also **historically significant as** a now rare surviving example of aspects of Fyansford's heritage.

Overall, the Junction Hotel ruins at 5-55 Fyansford-Gheringhap Road are of **Local Significance**.

References

1. Shire of Bannockburn Rate Books.
2. *Sands & McDougall's Directory of Victoria*.
3. John McNeill, *A Journey to Destiny 1890 - 1990*, Australian Cement Limited, 1990, p18
4. Derek Beaurepaire, *The Stepping Stone*, p33

PAGE 4 of 4