

Building

Small building between
Sir Robert Peel Hotel and
106-120 Cambridge Street,
facing Wellington Street

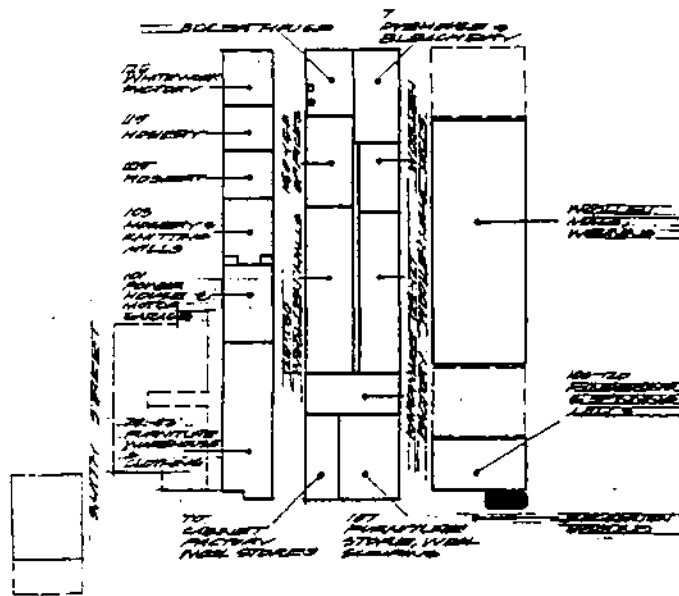

Allotment Reference

53

National Trust Register

Under consideration

National Estate Register

-

Historic Buildings Council Register

-

Location within Precinct

Collingwood Slope

Photograph Date:

30.3.1988

<u>Grantee</u>	S.A. Donaldson
<u>Original Owner</u>	Foy & Gibson Pty. Ltd.
<u>Present Owner</u>	
<u>Original Use</u>	
<u>Present Use</u>	Store
<u>Construction Date:</u>	pre 1923
<u>Architect</u>	
<u>Builder</u>	
<u>Description</u>	A small, detached two storeyed gable roofed with parapetted gable ends and oculus vent. brick building, with terra cotta roof tiles and facade details not unlike the Foy and Gibson's complex.
<u>Condition</u>	Good
<u>Integrity</u>	Good
<u>History</u>	
<u>Significance</u>	This small building contributes to the architectural character of the F & G complex.
<u>Recommendations</u>	Recommended for Planning Scheme protection.
<u>References</u>	
<u>Issue</u>	April 1988