

PLACE IDENTIFICATION FORM

ADDRESS

568 Glenferrie Road

TYPE

- Single Residence
- Multiple Unit Res.
- Shop
- Outbuildings
- Office
- Industrial Building
- Landscape feature
- Public building
- View
- Other

TITLE

EXISTING DESIGNATION

HBR GBR AHC NT VAS

STREETSCAPE LEVEL

1 2 3
 SIGNIFICANT SIGNIFICANT
 STREET TREES KERB & GUTTERS

GRADING

A B C D E
 KEYNOTE BUILDING

RECOMMENDED FOR

HBR/GBR AHC URBAN CONSERVATION AREA
 VAS PLANNING SCHEME PROTECTION
 CULTURAL LANDSCAPE OTHER

SURVEY DATE Nov. 91.

NEG FILE 68.10.

Title
 Vol.
 Fol.

THEME

- Early Settlement
- Mansions
- Victorian Garden Suburb
- Municipal dev.
- 1870s growth
- Garden villas
- Working enclaves
- Commercial Centres
- Edwardian Prosperity
- Interwar Housing
- Flats and Offices



CONSTRUCTION DETAILS

Date
 Architect
 Builder
 Elements

- Contributing garden hedge Original or early hard landscape layout
- Landmark tree Original or early fence

NOTABLE FEATURES/SIGNIFICANCE

See attached

INTEGRITY Good CONDITION Good
 Fair Fair
 Poor Poor

CROSS REFERENCED INFORMATION

Associated significant garden

The site information given above has been determined from external street level inspection.

568 GLENFERRIE ROAD

History

MMBW Drainage records suggest that this interwar period building was constructed c1937 for Mr. C.H. Ponsford of 331 Glenferrie Road, Hawthorn.²⁷ The designer and/or builder was most probably T.N. Foulds of 8 Oakdene Cres., Murrumbeena. Ponsford was there still in 1959.²⁸ A dental surgery was located in this building from the 1930s.²⁹

Description

A brick flats block showing Moderne and International style features. The building is executed in a cubic form with sharp corners and skyline, accentuated by the inset corner windows. A thin band of contrasting brick colouring is recessed at the parapet, elsewhere the wall surfaces are detailed by recessing or subtly projecting the wall plane. On the forward portion horizontal bands of brickwork extend between the corner windows. Curved porches are provided in glazed bricks, layed in soldier pattern subtle horizontal courses emphasise these elements. The balustrades, balconies and stairway are executed in fine steelwork to thin cantilevered concrete slabs. These elements introduce contrasting curved features.

The window joinery is timber, with horizontal glazing bars. The front fence adopts a detail matching the parapet.

Assessment

From the early 1930s domestic architects such as Roy Grounds, Stuart Calder, and Hopkins were designing houses which reflected the new movements in modern architecture developing in Europe from the 1920s. Two main streams developed, - the Moderne, either Jazz or Streamline and the International Style. The former had its basis in the 1925 Paris Exposition, the New York skyscraper and in German Architect, Mendelson's strongly expressed horizontality and smooth flowing movement. The International style was a complete rethink on the basis of architecture, relating form to function, using materials honestly and freeing designers from the revival styles. The two pushes mingled in Melbourne and were often confused by their common use of new materials and techniques, namely; cantilevered concrete slabs, flat roofs, horizontal emphasis and cubic form.

Flats, a modern building type, adopted the new styles with vigour in the 1930s.

This example located prominently on a major boulevard was in an ideal location to receive the attention which the new approach sought. In this type of setting, where mansions had previously dominated, the large flat blocks could sit comfortably with their neighbours in scale, and, given the generally high quality and provision of a substantial garden, could be readily appreciated in three dimension.

27. MMBW House Service Cover No. 201207 (1937-1960).

28. Ibid. (name of agent).

29. Ibid.

568 Glenferrie Road continued

This example combines elements from each of the two main style types. The cubic form corner windows and severe lines balanced by the projecting balcony elements are International Styles. The curved porches, and the brick banding are streamlined. Jennings designer, Edgar Gurney also used both styles at 3 Surrey Court, Ivanhoe 1938-39. Indeed A.V. Jennings did much to popularize this form for flats, houses and maisonettes.

Significance

Metropolitan

1. Architecturally significant as a well developed example of Moderne and International styling on high quality flats accommodation. Amongst the best examples of flats from the 1930s in Hawthorn.
2. Illustrative of the flat boom in Hawthorn in the 1920s and 1930s.
3. Illustrating the boulevard approach to design on Hawthorn's major thoroughfares.

Chief Draft

568 Glenferrie

Melbourne and Metropolitan Board of Works.

Litho No. 1505

Detail Plan No. 1505

Drainage Plan No. 201207

PLAN OF DRAINAGE

FOR

M.C.H. Ponsford, 331 Glenferrie Rd Hawthorn. Owner

T. N. Foulds, 8 Oakdene Cres. Murrumbeena. Agent

MUNICIPALITY: HAWTHORN

REFERENCE:

- | | | |
|--------------------------------|----------------------------------|--------------------------------|
| B.T. Boundary Trap | S.V. Stop Valve | I.O. Inspection Opening |
| D.T. Disconnecter Trap | S.T. Silt Trap | E.V. Educt Vent |
| G.T. Gully Trap | C.I.P. Cast Iron Pipe | I.V. Induct Vent |
| G.D.T. Gully Disconnecter Trap | G.W.I.P. Galv. Wrought Iron Pipe | S.I.V.P. Soil Induct Vent Pipe |
| G.I.T. Grease Interceptor Trap | S.P.D. Stoneware Pipe Drain | S.V.P. Soil Vent Pipe |
| G.S.T. Gully Silt Trap | I.C. Inspection Chamber | T.I.T. Triple Interceptor Trap |

(See By Law No.35)

Scale: 40 feet to 1 inch.

Accounting all...
 indicated by...
 shown and...
 section...
 and...
 GLENFERRIE RD

98'63

All existing Fittings to be abolished.

Additional...
LIST OF FITTINGS

1. Closet ~~to be~~ External G^d Floor
- 2.3. Closets " "
4. Bath " "
- 5.6.7.8. L. Basins " "
- 9.10. Dental Units " "
- 11.12. Sinks " "
- 13.14. Troughs " "
- 15.16. Closets Internal " 15"
- 17.18. Baths " "
- 19.20. L. Basins " "
- 21.22. Sinks " "
- 23.24. Garages " "

DENTAL UNIT NO. 10.

trough

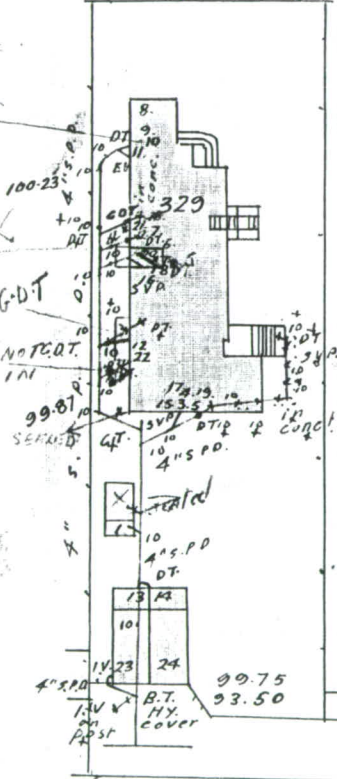

Storage Tank to be provided
 Drains to be laid shown in blue
 Pipes with ~~less than~~ 18" of cover, pipes
 near tree roots & pipes under building
 to be surrounded with 6" of cement
 concrete & walls arched over pipes
 I.V. to be moved to new position &
 adjusted to requisite height.
 Tap & apron to be provided to each G.D.T.
 Pipes not required are to be cut & sealed
 at all ends & O.B.^s

Work Carried Out To This Plan
 WASHING AREA TO BE PROVIDED
 AND CONNECTED WHEREVER
 ORDERED BY THE BOARD

R. Beattie

14 DEC. 1937

Examined, *[Signature]*

Engineer.

Melbourne, *9/1/37*

March 1959 o/o = C.H.S Ponsford.

July 1960 o/o = D.C. Newman.