

## PLACE IDENTIFICATION FORM

## ADDRESS

19 Anderson Road

## TYPE

- ☒ Single Residence      ☐ Multiple Unit Res.  
☐ Shop      ☐ Outbuildings  
☐ Office      ☐ Industrial Building  
☐ Landscape feature      ☐ Public building  
☐ View      ☐ Other

## TITLE

## EXISTING DESIGNATION

HBR ☐ GBR ☐ AHC ☐ NT ☐ VAS ☐

## STREETSCAPE LEVEL

1 ☐      2 ☐      3 ☒  
 SIGNIFICANT ☐ SIGNIFICANT ☒  
 STREET TREES      KERB & GUTTERS

## GRADING

A ☐      B ☒      C ☐      D ☐      E ☐  
 KEYNOTE BUILDING ☐

## RECOMMENDED FOR

HBR/GBR ☐      AHC ☒      URBAN CONSERVATION AREA ☐  
 VAS ☐      PLANNING SCHEME PROTECTION ☒  
 CULTURAL LANDSCAPE ☐ OTHER ☐

SURVEY DATE Aug/Oct. 91

NEG FILE 18.31.

Title  
 Vol.  
 Fol.

## THEME

- ☐ Early Settlement  
☐ Mansions  
☐ Victorian Garden Suburb  
☐ Municipal dev.  
☐ 1870s growth  
☒ Garden villas  
☐ Working enclaves  
☐ Commercial Centres  
☐ Edwardian Prosperity  
☒ Interwar Housing  
☐ Flats and Offices

## CONSTRUCTION DETAILS

Date 1921

Architect

Builder

Elements



- ☐ Contributing garden      ☐ Original or early hard landscape layout  
☐ Landmark tree      ☐ Original or early fence

## NOTABLE FEATURES/SIGNIFICANCE

See attached

INTEGRITY      Good ☒  
                  Fair ☐  
                  Poor ☐

CONDITION      Good ☒  
                  Fair ☐  
                  Poor ☐

## CROSS REFERENCED INFORMATION

Associated significant garden ☐

## 19 ANDERSON STREET

### History

D.G. Lockhart was the owner in 1921 of the brick house at 19 Anderson Street and was owner still in 1976.<sup>1</sup> The name of the designing architect or builder is unknown.

### Description

A Californian bungalow illustrating typical details of the style, namely: red brick walls with rough cast panels; strapwork gables; deep verandah; raked eaves with exposed rafters; a large expanse of tiled roof with wide eaves; timber windows; and a long low feeling which settles the house into its garden setting. This house is further elaborated by buttresses to the entrance porch, basket weave balustrading, and classical columns to the verandahs. The composition is purposefully asymmetrical creating interest from the balanced arrangement of planes and volumes.

The house sits prominently on its corner site, addressing both streets.

### Assessment

In the early decades of twentieth century the mansion houses which had very large allotments facing Burke Road and Auburn Road and Tooronga Road were progressively subdivided and new streets formed between. Anderson Road was major road in the Region, principally developed in the 1920s. The intersection of the streets in the recti-linear subdivision pattern became prominent sites and usually received high quality three dimensional designs, substantially more elaborate than the others in the streets, but intent in forming the visual impression of the region. Houses executed in Queen Anne style or its derivatives through the garden bungalow to the Californian bungalow, were ideal for the corner sites, on this relatively flat land, offering designs where gardens could dominate on the streets, with a balanced asymmetrical design which could address both streets.

The Queen Anne style, and some of the principals of Australian homestead planning and design combined around the turn of the century to produce a new suburban style which continued up to the end of W.W.1. Sometimes loosely referred to as "Edwardian" or "Federation" it is more appropriately referred to as "Garden Bungalow", because it does not relate just to the period around Federation at 1901, and because it is intimately related to the garden suburb concept. Buildings using similar details continued to be used in row houses. What sets the "garden bungalow" apart is the purposeful and close relationship with the garden as the dominant feature. A variety of decorative forms can be used within this.

This example is amongst the best in the Auburn Ward and of the key corner site houses amongst the best Californian bungalow designs in Melbourne, a style extensively used in the prospering 1920s.

---

<sup>1</sup>. MMBW House Service Cover No. 119749 (1921-1976).

19 Anderson Street continued

Significance

Metropolitan

1. A substantially intact house, typical of the high quality buildings which occupied the prominent corner sites in the Auburn Ward during the first decades of the twentieth century.
2. Amongst the best examples of Californian Bungalow styles in Hawthorn.



3M—8/21.

*[Faint handwritten notes at bottom]*

Plan  
Sheet No. 119249

Circular Manholes.....Square Manholes.....*1530*

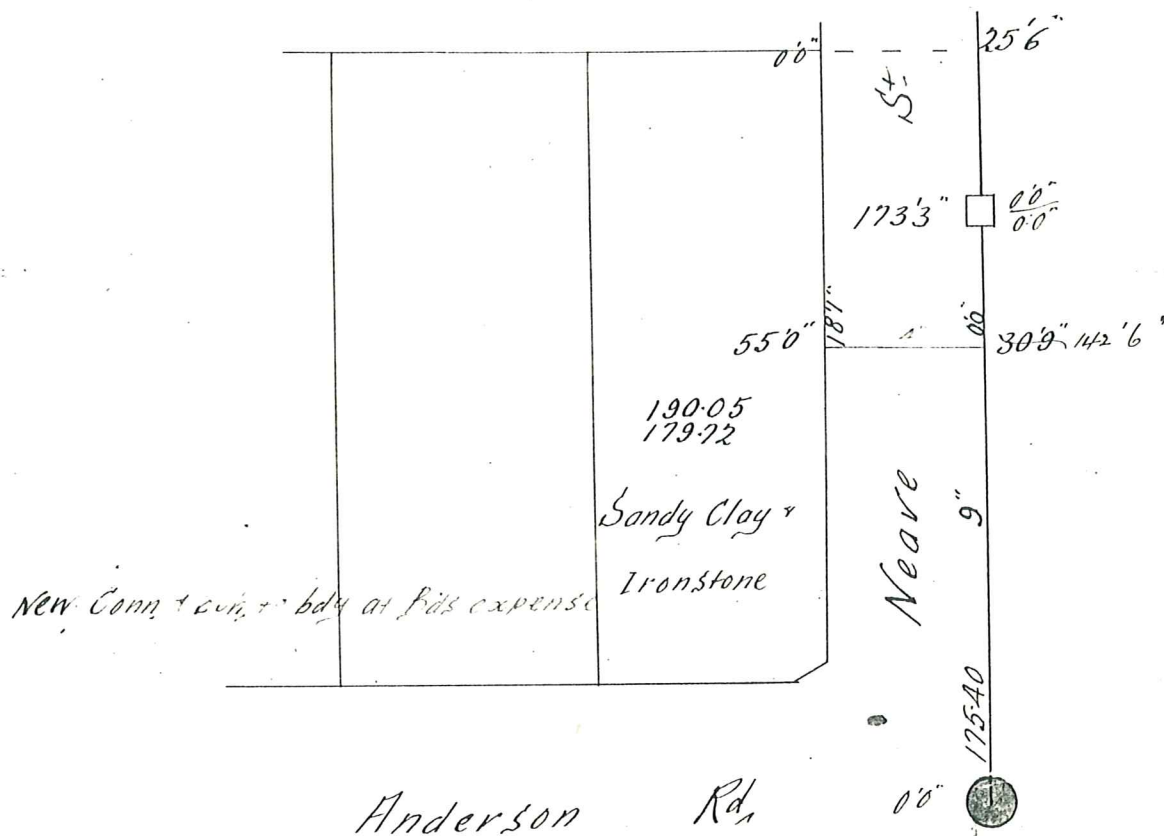

Plotted on litho  
9.5.22  
S.F.  
plotted P.P.  
S.F.  
23.5.22

7/112

D. G. Lockhart June 1921.

work carried out 1928<sup>Jan</sup> D.G. Lockhart

Work carried out Jan 1976 S. Dance (agent)

info  
found on  
inside  
file cover

on front cover owner listed as D.G. Lockhart, April 1921.

U. B. Doran  
7/8/3/22