

Manningham Heritage Garden & Significant Tree Study

Heritage Garden Information Sheet

Garden Identification No.: 14

Name of Property: Heide II Kitchen Garden

Location: Heide II property,
7 Templestowe Road,
Bulleen

Owner: The State of Victoria

History:

Original owner: Sidney Ricardo (1840's)

House –Designed By: David McGlashan
(McGlashan and Everest)

Built by: Unknown

Date: 1965-68

Additions (date) Conversion from house to art gallery (McGlashan and Everest, 1982)



Garden -Designed By: Sunday Reed

Built by: John and Sunday Reed

Date: c.1965

Additions (date, designer & type): None

Notes –

John and Sunday Reed were well known art patrons who encouraged and fostered artists such as Sidney Nolan, Albert Tucker and Joy Hester. Their original house, Heide I, became a centre for the modern art movement and a constant visiting place of a number of Artists. The Reeds aimed to be self-sufficient and to this end a Kitchen Garden was established at Heide I, with everyone who stayed having a working role in the garden. Freshly picked produce was an important part of every meal.

When the Reeds moved to their new house at Heide II a Kitchen Garden was established closer. This garden was designed by Sunday Reed to be both utilitarian and sensory and has a number of her individual stamps on it, including an impressive collection of Roses and Chervil imported from France.



Garden Style:

Geometric	X	Australian Native	English Landscape	Picturesque	Gardenesque (victorian)	
Edwardian		Bush	Australian suburban	Plantsman's	Other	X

Other: Kitchen or vegetable garden

Category of Significance:

Significant role in pattern of history	X	Demonstrating a rare/endangered aspect of history		May yield new historical information	X	Demonstrating a class of significant places	
Aesthetic value	X	High level of Creative/ Technical development representing a period	X	Valued by community for cultural, social or spiritual reasons	X	Associated with (or designed by) historical figure	X

Level of Significance: State

Main Elements:

Trees		Shrubberies		Lakes/ponds		Other	
Walling		Steps		Paving	X	Hedges	

Other: Geometric garden beds planted with vegetables, shrubs and Herbaceous Perennials.

Features:

Statuary		Fountain		Summer house/aviary		Gates		Pergola	
Terraces		Urns		Orchard		Kitchen Garden		Other	X

Other: Arbours and a Picket fence to prevent plants being washed away when the river flooded. Some stone paving is also present, similar to that at Heide I

Garden Plantings: Around 74 different cultivars of roses as well as perennials including geraniums, sedum, irises, eupatorium, viburnum, angelica and hellebores. Vegetables currently planted include brassicas (cauliflower or cabbage etc.), artichokes, peas, onions and beans, but these would change from season to season. A variety of herbs plus many more annuals and perennials are also present.

Condition & Integrity:

Excellent	X	Good		Fair		Deteriorated		Ruins	
Intact	X	Altered/extended sympathetically		Altered/extended un sympathetically		Disturbed or damaged		Restoration possible?	

Notes: The garden is intact, having retained Sunday Reed's original form and character, including the placement of the rose varieties and her method of staking. The garden is in excellent condition.

Maintenance Practice/ Requirements: Continue to maintain as is current practice, including weeding, managing the rotation and continual production of vegetables and keeping the current style of staking. The Rose varieties must also be retained as well as the general style of garden planting.

Existing Overlay Controls: Heritage Overlay (HO161), Environmental Significance Overlay (ESO1), Land Subject to Inundation Overlay (LSIO)

Significant Elements: The Kitchen Garden at Heide II is of state significance for its aesthetic, cultural and scientific value. It contains an excellent rose collection and was designed and used by the art patrons John and Sunday Reed, being closely linked with the artists which were constant visitors to their home. Significant elements of the garden are the garden bed and path layout, arbours, rose collection, picket fence and planting style.

Recorded by: Andrea Proctor

Date: 01-09-05

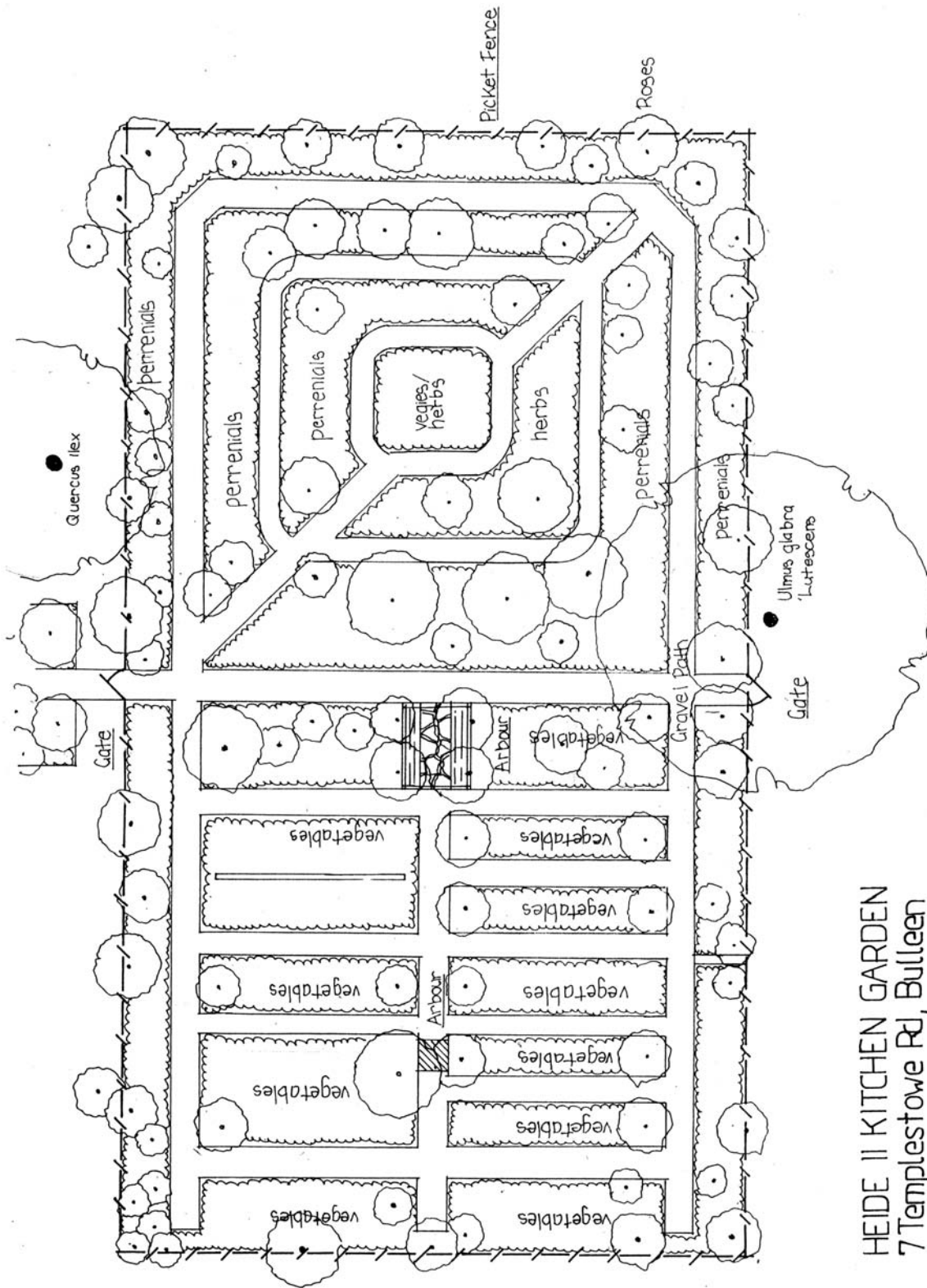

HEIDE II KITCHEN GARDEN
 7 Templestowe Rd, Bulleen
 Not To Scale

Additional Photos:

