

Manningham Heritage Garden & Significant Tree Study

Heritage Garden Information Sheet

Garden Identification No.: 89

Name of Property: "Yarragunyah"

Location: 29 Dellas Ave, Templestowe

Owner: Kathleen Mapperson

History:

Original owner: Leigh Tanner

House –Designed By: Unknown

Built by: Unknown

Date: c. 1960

Additions (date): The house as it currently stands was completed in 1986 when the original house, with the exception of its foundations and a couple of internal walls, was demolished and completely re-built. The bluestone foundations were retained; however the original bluestone retaining wall on the south side of the house was disassembled, moved back two metres and reassembled.



Garden - Designed By: Ellis Stones

Built by: Ellis Stones Crew

Date: 1961

Additions (date, designer & type):

Notes –

As mentioned above, one of the original bluestone retaining walls has been moved and the original entrance wall and wisteria have been removed. There has been some redesign on the terrace area due to the natural growth and senescence of trees, however much of the garden is intact.

Ellis Stones wrote about the garden extensively in his 1971 book, *Australian Garden Design*, describing the garden and its design. A number of original features as described in the book still remain, however some changes are also evident. The book also includes a number of photographs of the garden.

Source: E. Stones, *The Australian Garden Design*, Macmillan, 1971
A. Latreille, *The Natural Garden: Ellis Stones: His Life and Work*, Viking O'Neil, 1990

Garden Style:

Geometric		Australian Native	X	English Landscape		Picturesque		Gardenesque (Victorian)	
Edwardian		Bush	X	Australian suburban		Plantsman's		Other	

Other: The garden was originally a primarily native garden with selected exotic plants used to add colour. The garden contains an extensive amount of Ellis Stones' rock work.

Category of Significance:

Significant role in pattern of history		Demonstrating a rare/endangered aspect of history		May yield new historical information		Demonstrating a class of significant places	X
Aesthetic value	X	High level of Creative/ Technical development representing a period	X	Valued by community for cultural, social or spiritual reasons		Associated with (or designed by) historical figure	X

Level of Significance: Regional

Main Elements:

Trees	X	Shrubberies		Lakes/ponds		Terraces	X		
Walling	X	Steps (rock and timber)	X	Paving		Rockwork	X		

Other: Two open terraces connected by gravel paths running through garden beds. Large trees have been planted within garden beds and as accents in more open areas of the garden. The steep slope has been negotiated by a mix of stairs (formal and informal) and graduated paths. Original Ellis Stones rockwork, paving and bluestone walls are present.

Features:

Statuary		Fountain	X	Summer house/aviary		Gates		Brush Fences	X
Terraces	X	Urns		Orchard		Kitchen Garden		Barbeque	X

Other: Sundial and Brush fences are original features; however the fountain on the terrace is a recent addition.

Garden Plantings: Original plantings would have been primarily native where they met the river, with more exotic plantings in the upper portions of the garden. Original plantings included Eucalypts, Rhododendrons, Fringe Flowers (*Loropetalum chinensis*) and tufted plants such as *Dietes*.

A number of original garden plantings are present including large Eucalypts (*Eucalyptus ?viminalis*, *Corymbia citriodora*, *C. maculata* and others), some Camellias and original clumps of Wild Iris (*Dietes* sp.). The second owner of the property planted Camellias and Azaleas as well as *Agapanthus* which has overrun the garden, smothering much of the original plantings. Fish bone fern (*Nephrolepis* sp.), Ivy (*Hedra helix*) and Sweet Pittosporum (*Pittosporum undulatum*) have also become weedy in the garden and Ginger (*Hedychium* sp.) is another recent addition.

Other garden plantings include Variegated Lily Turf (*Liriope muscari* 'Variegata'), Winter Rose (*Helleborus orientalis*), Saxifrage (*Bergenia x schmidtii*), Bromeliads (*Aechmea* sp.), Seaside Daisy (*Erigeron* sp.), Climbing Fig (*Ficus pumila*), Sacred Bamboo (*Nandina domestica*), Bird of Paradise (*Strelitzia reginae*), Rough Tree Fern (*Cyathia australis*), Cherry Laurel (*Prunus laurocerasus*), Mock Orange (*Philadelphus* sp.), Evergreen Viburnum (*Viburnum* sp.), Elm (*Ulmus* sp.), Cedar (*Cedrus* sp.), Silky Oak (*Grevillea robusta*), and Japanese Maple (*Acer* sp.). Original Birch trees (*Betula* sp.) present on the top terrace died during the recent drought and have been removed.

Condition & Integrity:

Excellent		Good (Structure)	X	Fair		Deteriorated (Planting)	X	Ruins	
Intact	X	Altered/extended sympathetically		Altered/extended unsympathetically		Disturbed or damaged		Restoration possible?	Y

Notes: A number of both sympathetic and unsympathetic alterations have been made to the garden. The replacement of lawn with bluestone edged gravel beneath feature trees is largely sympathetic and has occurred in response to growing trees out-competing lawn. The replacement of stairs has also been sympathetically undertaken in response to the deterioration of the original timber structure.

Planting by the second owners of Camellias, Azaleas and *Agapanthus* is unsympathetic and has led to the loss of many original plantings. Some restoration is possible and is taking place, with weedy *Agapanthus* being removed. The fountain on the terrace is also unsympathetic.

The layout, including terraces, rockwork, and major trees is original and intact.

Maintenance Practices/Requirements

The garden is currently being maintained by Lawn & Garden Australia (David Ellis) with there being an attempt to restore the garden sympathetically. This should continue with weed species such as Ivy, Pittosporum, Fish Bone Fern and *Agapanthus* being removed and replaced with species traditionally associated with Ellis Stones' work.

Other non-sympathetic elements should be removed including recent plantings of nontraditional species (e.g. Maple on the top terrace and plastic garden edging).

Tree health and structure should also be monitored by a qualified arborist.

Existing Overlay Controls:

Design & Development Overlay (DDO4), Environmental Significance Overlay (ESO1), Significant Landscape Overlay (SLO3).

Significant Elements:

Terraces, Bluestone retaining-walls, rockwork, original paving, original stairs, path layout, brush fences, structural planting (all original trees, shrubs and groundcovers).

Recorded by:

Andrea Proctor

Date:

10-3-06

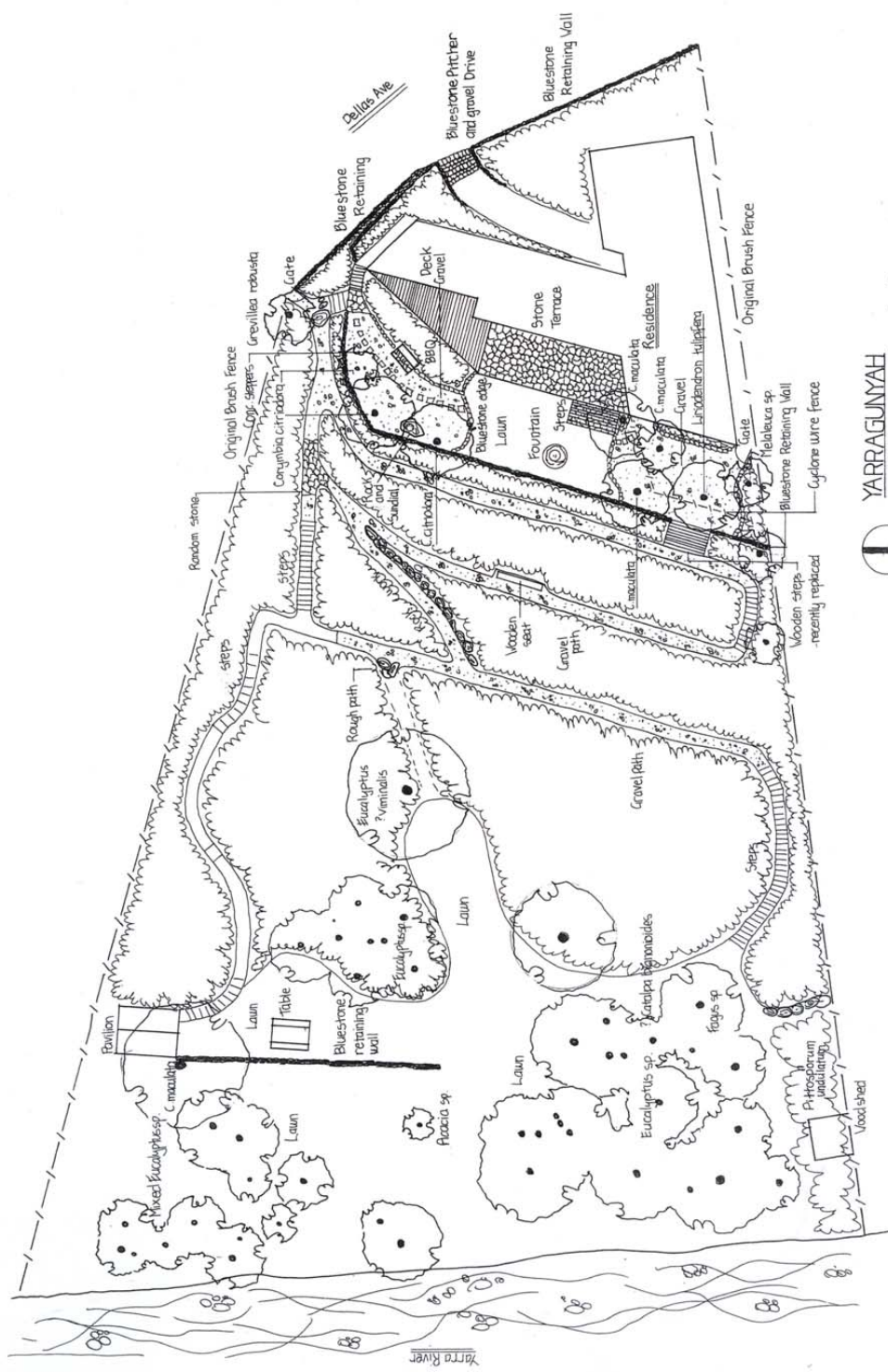

YARRAGUNJAH
 29 Dallas Ave Templestowe Not to Scale



Additional Photos:

