

PLACE IDENTIFICATION FORM

ADDRESS

675 Burke Road

TYPE

- Single Residence
- Shop
- Office
- Landscape feature
- View
- Multiple Unit Res.
- Outbuildings
- Industrial Building
- Public building
- Other

TITLE

EXISTING DESIGNATION

HBR [] GBR [] AHC [] NT [] VAS []

STREETSCAPE LEVEL

1 [] 2 [x] 3 []
SIGNIFICANT [] SIGNIFICANT []
STREET TREES KERB & GUTTERS

GRADING

A [] B [] C [x] D [] E []
KEYNOTE BUILDING [x]

RECOMMENDED FOR

HBR/GBR [] AHC [] URBAN CONSERVATION AREA [x]
VAS [] PLANNING SCHEME PROTECTION [x]
CULTURAL LANDSCAPE [] OTHER []

SURVEY DATE Nov. 91.
NEG FILE 46.28-30-
Title
Vol.
Fol.

THEME

- Early Settlement
- Mansions
- Victorian Garden Suburb
- Municipal dev.
- 1870s growth
- Garden villas
- Working enclaves
- Commercial Centres
- Edwardian Prosperity
- Interwar Housing
- Flats and Offices

CONSTRUCTION DETAILS

Date 1912
Architect W. H. Smith
Builder
Elements
House and garden.



- Contributing garden
- Landmark tree
- Original or early hard landscape layout
- Original or early fence (altered early)

NOTABLE FEATURES/SIGNIFICANCE

Corner gates, doctors entrance.
See attached

INTEGRITY Good [x]
Fair []
Poor []

CONDITION Good [x]
Fair []
Poor []

CROSS REFERENCED INFORMATION

Associated significant garden []

675 BURKE ROAD

History

Now used as a doctor's residence, this villa with its original fence was the home in 1912 of Alice Rosenthal. Its designing architect was W.H. Smith,¹³ who was associated with a number of Melbourne buildings between 1888 and 1913.¹⁴

Description

A Queen Anne house occupying three sides of a tiny subdivision block. The use of this highly three dimensional style makes good use of prominence from three streets.

Assessment

In contrast to our current perception of a desirable street in which to reside, up to the second world war, it was the busy major thoroughfares and boulevards which attracted the best quality homes. In the central city, this role was filled by St. Kilda Road. In East Melbourne by the mansions along Victoria Parade on the hill. In other suburbs a similar pattern followed. Transport routes, readily available access to bridges, and better roads, contributed to the higher price for land on major boulevards, but more important was the desire to publicly express wealth with a prominently visible residence.

Within each subdivision the high ground attracted the very best developments. This pattern is well illustrated at Hawthorn along Burke Road, Riversdale Road and Glenferrie Road. Big houses located here, illustrating the fashions of the time. Mansions on the hill, and the next best villas adjoining. This approach continued up to the second world war. In Burke Road pockets of excellent housing exhibiting the best standards for their time of construction, can be traced from Gardeners Creek with 1920s California Bungalows, through Edwardian garden villas, to Boom period mansions on the hill south of the junction.

Hawthorn's major boulevards, illustrate in shorthand form, the major building patterns and the inspirations of the residents through the various periods of the suburb's life.

Significance

1. A late example of the Queen Anne style and of the work of W.H. Smith which contributes to the stretch of substantially intact high quality villas built early this century.

¹³. MMBW House Service Cover No. 85578 (1912-1964).

¹⁴. Miles Lewis, "Australian Architectural Index".



675 Burke Road

675 Burke Rd. 04
2000-7/07 15/11/15 17

The Melbourne and Metropolitan Board of Works.

Litho No. 1535

Detail Plan No. 1535

Drainage Plan No. 85578

P 8
242

PLAN OF DRAINAGE FOR

M. Alice Rosenthal, Burke Rd Hawthorn Owner.

W.H. Smith 28 Market St Melb. Agent.

MUNICIPALITY: CITY OF HAWTHORN.

REFERENCE:

- | | | |
|--------------------------------|----------------------------------|--------------------------------|
| B.T. Boundary Trap | R.T. Reflux Trap | E.V. Educt Vent |
| D.T. Disconnector Trap | S.T. Silt Trap | I.V. Induct Vent |
| G.T. Gully Trap | C.I.P. Cast Iron Pipe | S.I.V.P. Soil Induct Vent Pipe |
| G.D.T. Gully Disconnector Trap | G.W.I.P. Galv. Wrought Iron Pipe | S.V.P. Soil Vent Pipe |
| G.I.T. Grease Interceptor Trap | S.P.D. Stoneware Pipe Drain | V.P. Ventilating Pipe |
| G.S.T. Gully Silt Trap | I.C. Inspection Chamber | M.F. Mica Flap |
| S.V. Stop Valve | I.O. Inspection Opening | |

(See Sewerage Regulations By-Law No. 8.)

Scale—40 feet to 1 inch.

SUPERVISION COPY

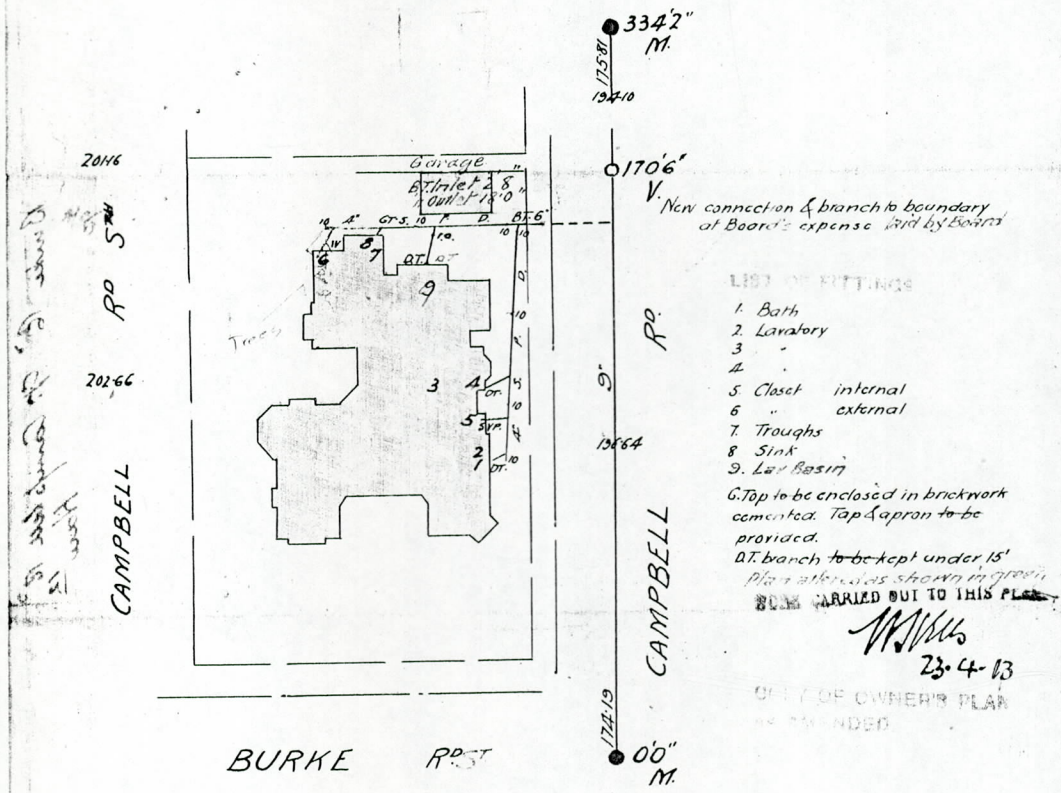

Examined, *[Signature]*

[Signature]
Engineer.

Melbourne, 30. 11. 1912

12.10.64 o/o = Dr L.T. Moran (shower & basin work).