

**Building**  
79-93 Oxford Street

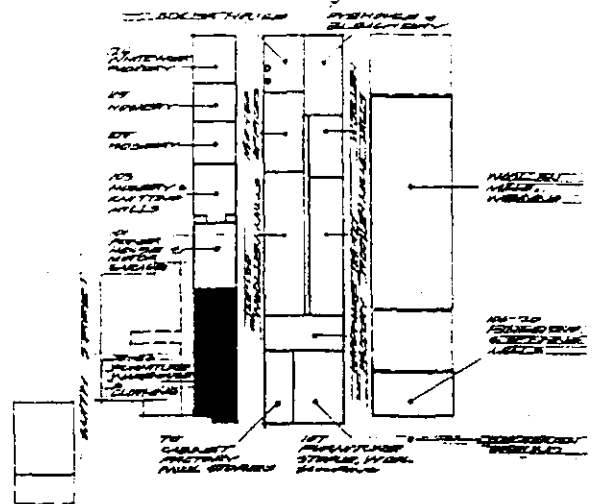

Allotment Reference

52 & 68

National Trust Register

Under consideration

National Estate Register

Recommended

Historic Buildings Council Register

Registered

Location within Precinct

Collingwood Slope

Photograph Date:

30.3.1988

<u>Grantee</u>	S.A. Donaldson
<u>Original Owner</u>	Foy & Gibson Pty. Ltd.
<u>Present Owner</u>	
<u>Original Use</u>	Furnishings Warehouse, Clothing Factory
<u>Present Use</u>	Richard Allen Pty. Ltd.
<u>Construction Date:</u>	1897-99 (4 storeyed building) 1900 (to south) 1908 (to north)
<u>Architect</u>	probably William Pitt
<u>Bulder</u>	
<u>Description</u>	<p>A complex of buildings, built over a period, and having a four storeyed building as its central feature. This building is distinguished by round arched window openings and pediment with acroterion and volute decoration. A cornice line at fourth floor level is typical for the Foy and Gibson complex. Inside, a warehouse at street level is accessible off Oxford Street via two r.s. doors and is spanned by rivetted steel beams. Upper levels have Corinthian capital cast iron columns with timber beams, the third floor roof trusses being exposed. Warehouse space at ground level to the north is surmounted by administration space. To the south, both street level and the upper level is in use for warehousing, the roof being noteworthy for two large and one small timber lined lanterns, finished in two tone varnished timber with turned struts, t. and g. linings, chamfered chords and iron connectors. Columns are fluted Corinthian order in cast iron. The main (4 storeyed) building connects with the two storeyed sections to the north and south and also has metal bridge connections with curved corrugated iron roofs recalling the now removed Little Oxford Street bridges. Internally, at warehouse level, the former laneways which separated the components of the complex into 5 separate buildings are clearly visible, although now converted into internal space. Outside, facing Oxford Street, the main facade is relieved by segmental arched openings with r.s. doors, which reflect (?) the laneway locations, one such archway retaining its original fenestration with double timber pedestrian doors.</p>

The west facade bears clear evidence of the removed pedestrian bridges over Oxford Str which connected the manufacturing/warehouse activities with the Smith street store.

Condition:

Good

Integrity:

Good

History

The four storeyed building was built prior 1899 (MMBW litho) at a time when the company engine house and laundry existed immediately to the north. At this time, land to the south was vacant. It was built on in 1900 (la vacant 1900 RB). Prior to this (1891 S & dir), it was occupied by the "Oxford Arms hotel and by houses. To the north of three storeyed building, the present building replaced the engine house and laundry in 1900 (1908 RB deletes entry for houses at 109-107).

Significance

The four storey building is the oldest remaining F & G building in Collingwood and has a distinctive form and facade treatment. The cast iron columns and bridges are of interest in their own right and important in as far as contemporary interpretation of the growth of the F & G complex is concerned. The architecture of the roof lanterns, (and columns), adjoining to the south is of great significance as an intact and elaborate example of this ceiling form (former carpet showroom). The evidence of the Little Oxford Street bridges and the now internal laneways is also of interest.

The entire building group forms the south termination of the Oxford Street west side facade and is important also on this account as well as for its probable link with William Pitt, architect, and City of Collingwood councillor.



## Carpet Department.



CARPET SHOW ROOM.



11500.

h Axminster Carpets  
y and border at 15'6  
rd, made ready for  
or. These are three  
newest designs in  
ter Carpets.

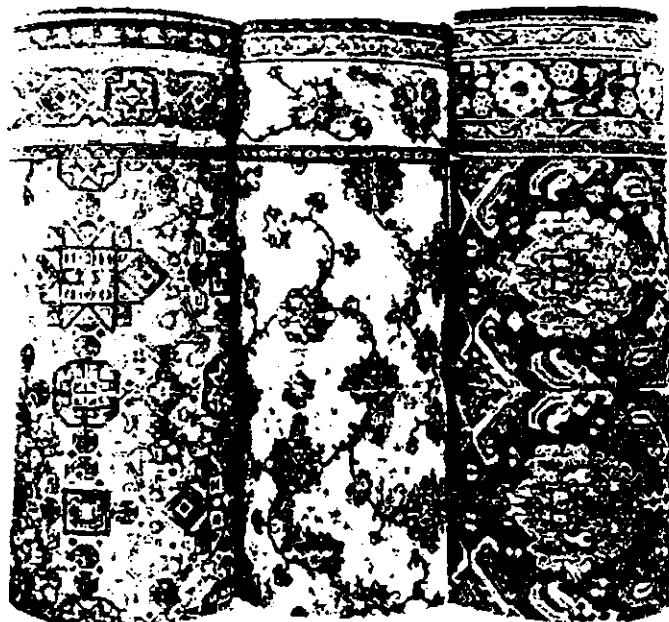

No. 4 is a beautiful  
ground with blue sh  
Good diningroom carpe

No. 5 is a fawn gr  
with maroon, beau  
traced to suit ground v

No. 6 is a dark  
ground, terra cotta col  
handsome dining carpe

Send size of c  
required and we will  
estimate.



Recommendations

Recommended for inclusion on the National Estate register and for Planning Scheme protection.

References

M.U. archives  
S & M directories  
Rate Boks  
Reprint of the Original Catalogue 1923: Foy and Gibson

Issue

May, 1995



Oxford St  
north end

Little  
Oxford St