

BACCHUS MARSH HERITAGE STUDY.

Ref: 233

Richard Peterson Architect & Conservation Consultant. Daniel Catrice Historian 1994.

NAME: Caroline Chisholm Society**PREVIOUS NAME:** Wiljim'e.**ADDRESS:** 30 Gell Street (SE cnr Lerderberg Street).**TITLE DETAILS:****USE:** Private hospital**PREVIOUS USE:** House**CONSTRUCTION DATE:** Late 1940s**SOURCE:** 1**CRITERIA:** H1; Ar1,3.**HISTORIC THEME:** Townships.**DESCRIPTION:** STYLE: Villa STORIES: 1 DETACHED.**MATERIALS:** WALLS Brick ROOF Marseilles tiles glazed STRUCTURE Lb**CONDITION:** Very good INTACTNESS: Excellent THREATS: Conversion.**SIGNIFICANT INTACT ELEMENTS:**

MATERIALS. FORM. VERANDAH. USE.

VERANDAH DECORATION.

DOORS. WINDOWS. PAINTWORK SCHEME.

OUTBUILDINGS.

STREET FURNITURE. FENCES/GATES.

SIGNIFICANCE:**TYPE:** HISTORICAL. ARCHITECTURAL.**LEVEL:** LOCAL.**DESIGNATION EXISTING:** Nil**RECOMMENDED CONTROL:** PLANNING SCHEME.

AREA 2.

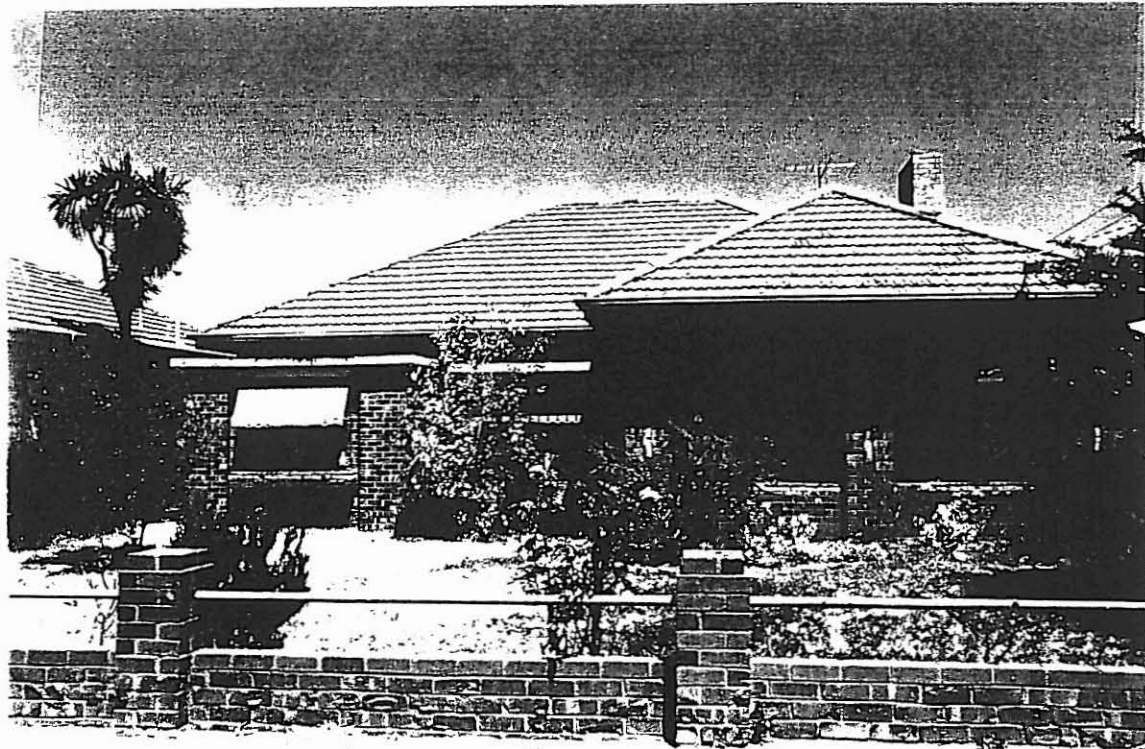
MAP NO: U4.07**SURVEY:** RP**DATE:** 7.1.94**NEGS:** 19.8-10

MAIN

268

SHADED AREAS ARE RECENT

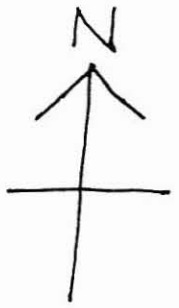

STREET

No. 268

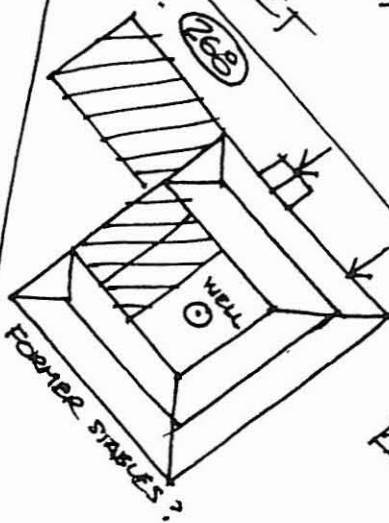

FORMER STABLES?

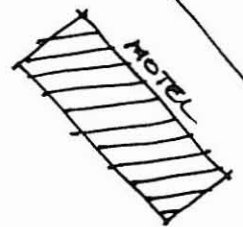

MOTEL