

BACCHUS MARSH HERITAGE STUDY.

Ref: 192

Richard Peterson Architect & Conservation Consultant. Daniel Catrice Historian 1994.

NAME: ---**ADDRESS:** 6 Gisborne Road.**TITLE DETAILS:****USE:** House (?)**SIGNIFICANT DATE:** 1860-99**CONSTRUCTION DATE:** 1860**SOURCE:** 1**CRITERIA:** H1,3; Ar 1**HISTORIC THEME:** Townships**DESCRIPTION:****STYLE:** Early**STORIES:** 1**DETACHED.****MATERIALS:****WALLS** Brick and stone**ROOF** Iron**STRUCTURE** Lb**CONDITION:**

Good

INTACTNESS: Fair**THREATS:** Traffic, ground level raised.**SIGNIFICANT INTACT ELEMENTS:**

MATERIALS. FORM. FACADE. VERANDAH. USE.

CHIMNEYS.

OUTBUILDINGS.

FENCES/GATES.

CONTEXT. 8 & 10.

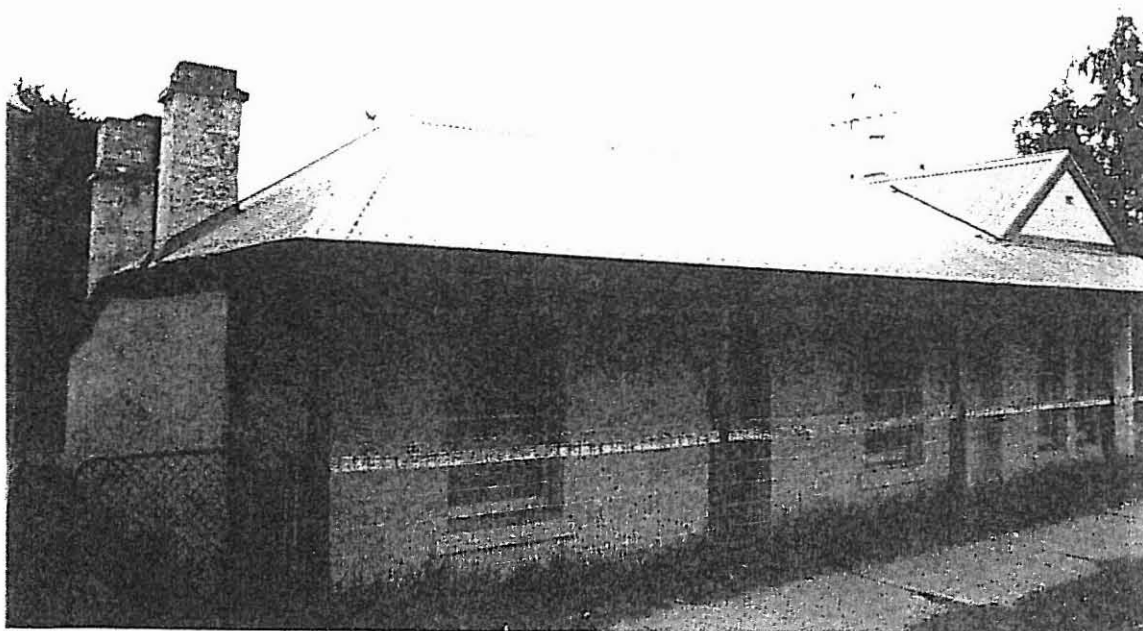
SIGNIFICANCE:**TYPE:** HISTORICAL. ARCHITECTURAL.**LEVEL:** LOCAL.**DESIGNATION EXISTING:** HBCR. PLANNING SCHEME.**RECOMMENDED CONTROL/NOMINATION:** HBR. RNE. PLANNING SCHEME.
AREA 1.**MAP NO:** U4.07**SURVEY:** RP**DATE:** 29.1.94**NEGS:** 15.14, 16, 20, 21

HISTORY: This house, part of a group of three buildings associated with the *Bacchus Marsh Express*, was erected circa 1860 as a private residence for George Lane, bookbinder, and first printer of the newspaper founded in July 1866.¹ Lane arrived in Bacchus Marsh in the 1850s, working as a builder for his brother-in-law, William Watson, then establishing a business as a bookseller, stationer and printer. By 1865, he was working from a shop, the rear room of the former *Express* office (ref: 193). In the following year, Lane was a member of the syndicate which published the first edition of the *Bacchus Marsh Express*, and when this syndicate folded several months later, he entered into a partnership with Christopher Crisp to assume control of the newspaper. Lane retired in 1899, having steered the paper through its most influential period. The residence alongside the *Express* office passed to a son, Anthony George, and remained in family ownership until 1984.²

VISUAL DESCRIPTION: Double-fronted symmetrical early ashlar stone cottage, from which a gable-roofed brick wing projects slightly, at right. This has a pair of tall windows, its chimney has an octagonal terra-cotta pot and a timber section at rear. The roof extends front over the verandah, across the front. All walls are rendered, except the two massive internal chimneys (which reveal ashlar above window-head height, beneath the verandah. There is ashlar stone, tooled in the front. The outbuilding (wash-house and kitchen?) is timber, with massive detached chimneys. Timber shingles remain under the corrugated steel roofing³ There is a woven wire fence, pedestrian and vehicular gates.

COMPARATIVE ANALYSIS: Nos. 6, 8 and 10 Gisborne Road form the group associated with the *Express* (also ref. 193 and 134). There are 16 early houses in Bacchus Marsh. This differs from others in its location so near the centre of the town and in having the right-angle wing, which may be later.

SIGNIFICANCE: An early brick house, built about 1860 for George Lane, first printer of the *Bacchus Marsh Express* newspaper (1866).

It is part of a group of three buildings (also refs: 193 & 194) associated with the newspaper. It was owned by the Lane family for 124 years.

This house is of state historical significance as part of a group associated with the then important and influential *Bacchus Marsh Express*. The *Express*, through its forceful intelligent editor Christopher Crisp, was influential on Alfred Deakin and the Australian Federation movement at the end of the nineteenth century. It is a representative embodiment of a way of life and associated with an industrial process, newspaper printing and publishing over the period 1865-1899.

¹ Moore, "Express Office", typescript, BMDHS.

² Ibid; *Age*, 28 January 1984.

³ Schematic plans, prepared by 'G.L.', 8 January 1981, held National Trust of Australia (Victoria) Building File No. 3982.

Finally it is of local architectural significance as an early house, surviving in the centre of the town.

INTACTNESS: Fair. Chimneys have been extended in brick. Doors and windows have been replaced. It has been re-roofed, perhaps altering the roof shape. The right hand wing is probably later. The later fence and gates are sympathetic. The outbuilding appears particularly intact. Colours are appropriate.

CONDITIONS & THREATS: Good. The ground level has now risen all around and is often above floor level, allowing damp to intrude. Paintwork is deteriorating.

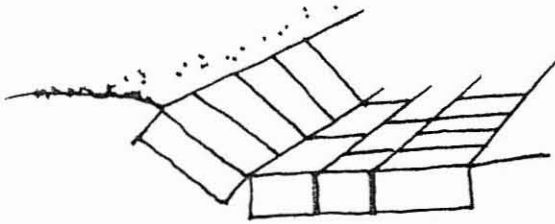

DETAIL
BRICK KERB & CHANNEL

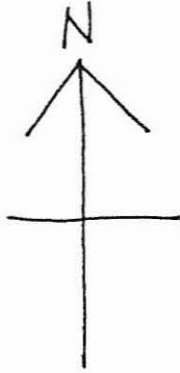

BRICK KERB & CHANNEL
(REFER DETAIL)

DIAMOND CONCR. FOOTPATH

OPEN

ROAD

GISBORNE

MAIN

STREET

(194) No. 10.

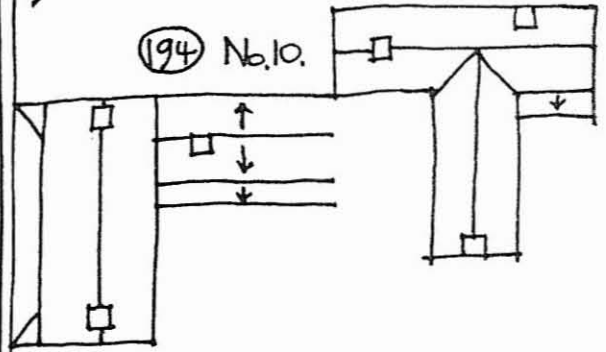

1966

(193) No. 8.

c 1883-1900

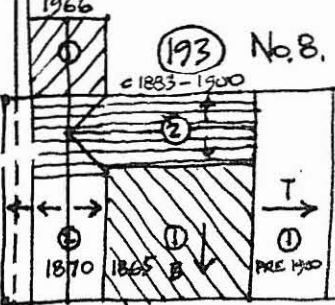

1860

1910

(192) No. 6.

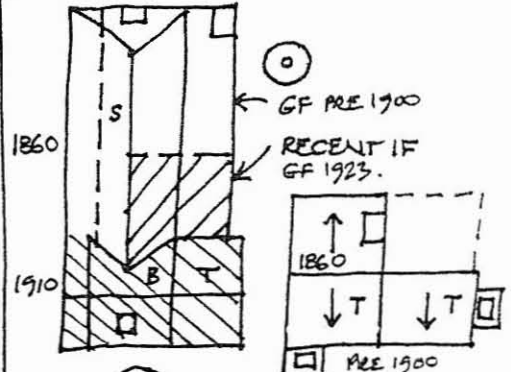

GF PRE 1900

RECENT IF
GF 1923.

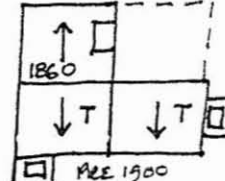

No. 4

LANE

(149)

COURT HOUSE HOTEL