

BUILDING IDENTIFICATION FORM

RICHMOND CONSERVATION STUDY

BUILDING ADDRESS Bendigo Street

BUILDING TITLE Former Wertheim Piano Factory

TYPE GTV 9 Studios
If not residence

EXISTING DESIGNATION HBR NER NTC

GRADING A B C D E F

STREETSCAPE 1 2 3 **CONSERVATION AREA**

SURVEY DATE 25.6.84 **NEG. FILE** 6-32,33

PERIOD

Early Victorian Edwardian
Victorian
Late Victorian

CONSTRUCTION DATE Source

MATERIALS

Walls Brick Roof T.C. Tile

FORM

Attached Detached

SIGNIFICANT FEATURES

early paint colour scheme	<input type="checkbox"/>	eaves, roof or gable decoration	<input checked="" type="checkbox"/>
original unpainted wall finish	<input checked="" type="checkbox"/>	intact verandah decoration	<input type="checkbox"/>
ornamental wall detailing	<input checked="" type="checkbox"/>	early fence	<input type="checkbox"/>
original doors/windows	<input checked="" type="checkbox"/>	early garden	<input type="checkbox"/>
intact verandah structure	<input type="checkbox"/>	other prominent contrib. elevations	<input checked="" type="checkbox"/>
original parapet	<input checked="" type="checkbox"/>		<input type="checkbox"/>
original roof form & finish	<input checked="" type="checkbox"/>		<input type="checkbox"/>
original chimneys	<input type="checkbox"/>		<input type="checkbox"/>



INTEGRITY RATING excellent good fair poor

ALTERATIONS & SPECIFIC GUIDELINES

No.	Sympathetic	S.G.	Inappropriate	S.G.	Extremely Inappropriate	S.G.

O = reinstate original designs S = reinstate sympathetic alternative R = remove RAM = Remove by approved method

COMMENTS

FORMER WERTHEIM PIANO FACTORY **Bendigo Street**

History and Description

Constructed in 1909 to the design of architect Nahum Barnet. The builder was R. McDonald. The owner was Hugo Wertheim who after a study of European and American factories decided to have the factory area on one floor with only offices on the first floor, a somewhat new concept for large factories in Australia. The site covered four acres and a tramway system was laid through the building and to the timber stores at the rear. The floor area was 50,000 square feet. The factory was capable of producing 2,000 pianos a year.

Practically every part of a piano was made in the factory, and for this purpose iron and brass foundaries, timber seasoning racks, wood working equipment, cabinet making, french polishing and sounding board facilities were provided. The factory generated its own power and it was heated by hot air pipes. Lavatories, luncheon rooms and smokers pavilions were built for employees. Fire proof divisions and steel doors were provided for fire isolation and a new type of dampcourse was laid in the walls.

Some of the staff had been trained in the leading European piano factories, and the pianos were claimed to compare favourably with any in the world.

Statement of Significance

A remarkably intact Edwardian factory building, formerly the largest piano factory in Australia, designed by the important architect Nahum Barnet.

References

Table Talk, 29th November 1908 p. 10.



HUGO WERTHEIM

THE WERTHEIM PIANO FACTORY.
RICHMOND NEAR MELBOURNE.

CENTRAL SHOWROOMS
294-296
BOURKE STREET.

THE WERTHEIM SEWING MACHINE FACTORY

HEAD OFFICES & WAREHOUSE
171-173, WILLIAM STREET.

Melbourne.

Wertheim Piano Factory, undated.
(La Trobe Library picture collection.)

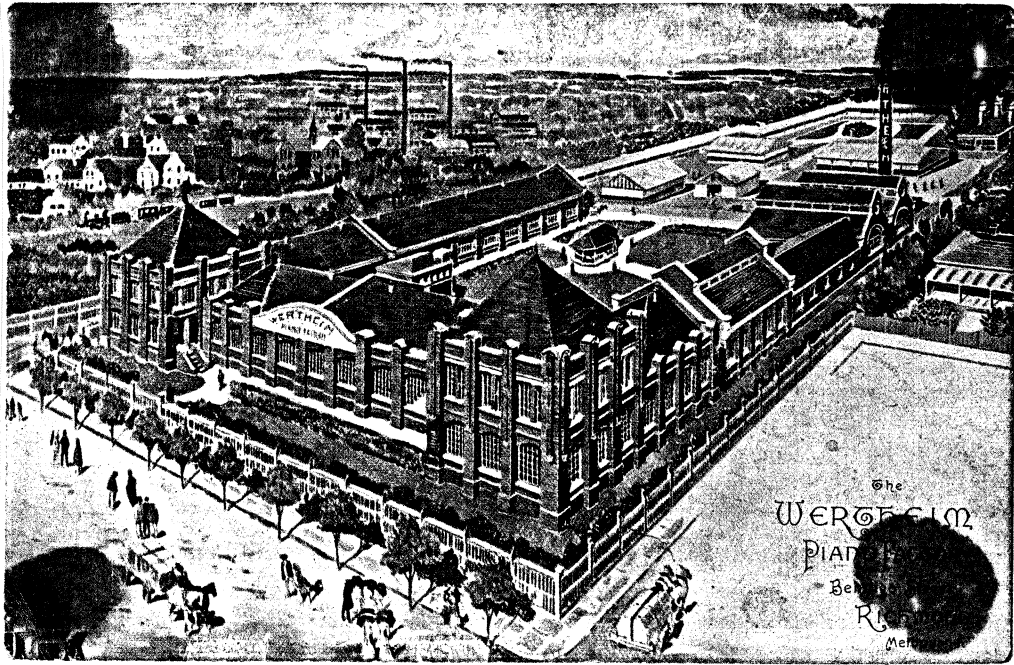

Wertheim Piano Factory, undated.
(La Trobe Library picture collection.)

LOCATION MAP

PROPERTY: 22-46 Bendigo Street

BUILDING CLASSIFICATION: B

URBAN CONSERVATION PRECINCT: Existing Proposed

APPROXIMATE SITE AREA: _____

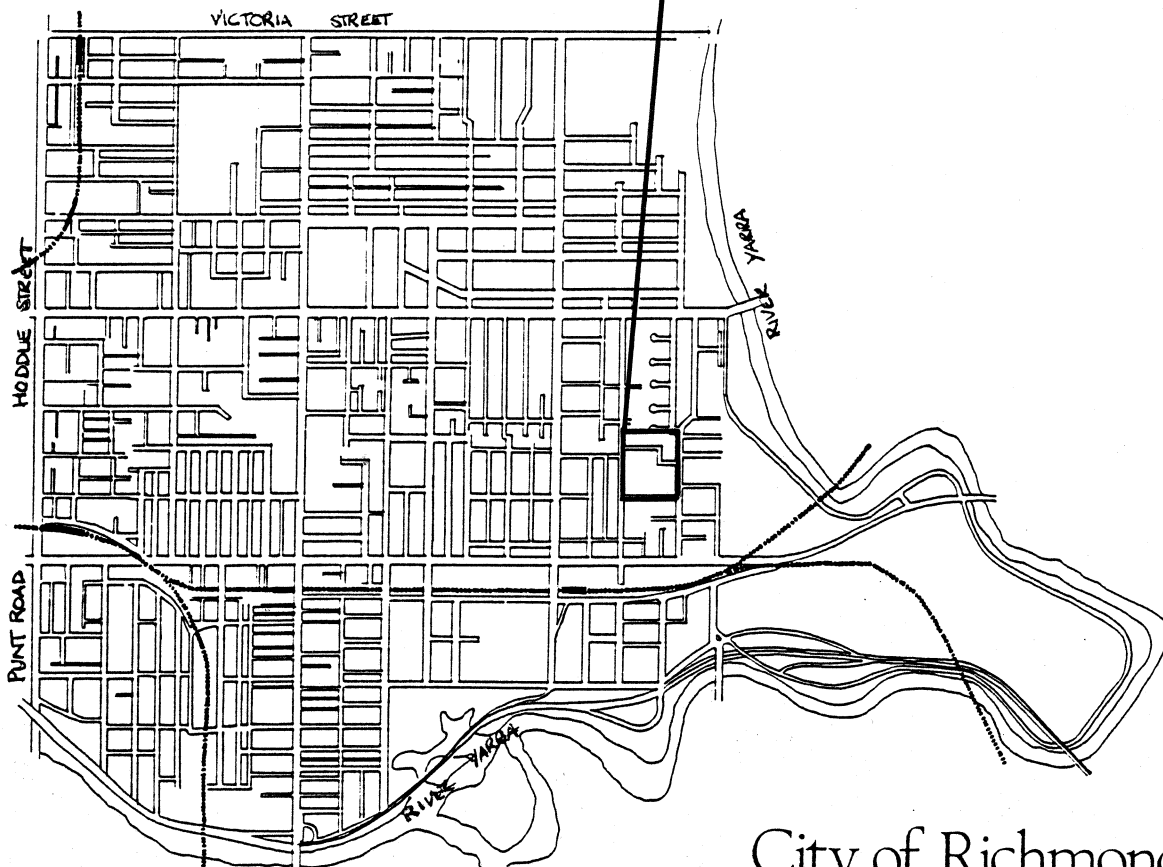
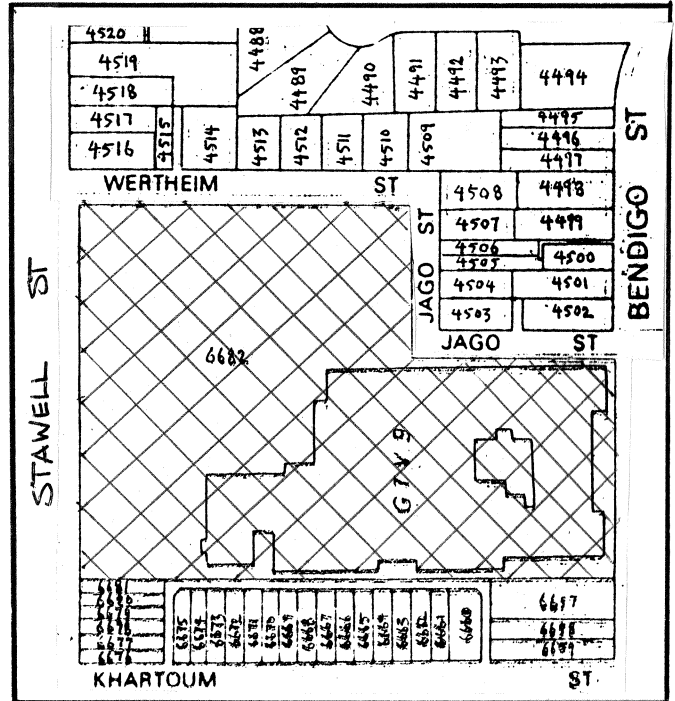

City of Richmond