

NEWTOWN URBAN CONSERVATION STUDY. - 'C' CITATIONS. Ref: 246
 Richard Peterson Architect & Conservation Consultant. 1997.

| | | | |
|--|------------------------------|--------------------------------|----------------------------------|
| NAME: — | | | |
| ADDRESS: 10 Virginia Street | | | |
| USE: House | | | |
| SIGNIFICANT DATE: | | CONSTRUCTION DATE: 1917 | |
| SOURCE: 1 | | | |
| DESIGNER: — | | BUILDER: — | |
| CRITERIA: H1; Ar1 | | HISTORIC THEME: 2.3 | |
| DESCRIPTION: | STYLE: Edwardian | STORIES: 1 | DETACHED. |
| MATERIALS: | WALLS: Timber | ROOF: Colorbond | STRUCTURE: Stud |
| CONDITION: Good | INTACTNESS: Very good | THREATS: — | |
| SIGNIFICANT INTACT ELEMENTS: | | | |
| FORM. FACADE. VERANDAH. ROOF FORM. GABLE DECORATION. VERANDAH DECORATION. CHIMNEYS. Pots. WINDOWS. GARDEN STRUCTURE. Arbour. CONTEXT Nos: 11, 12, 13 & 14. | | | |
| SIGNIFICANCE: | | | |
| TYPE: HISTORICAL. ARCHITECTURAL. | | | |
| LEVEL: LOCAL. | | | |
| DESIGNATION EXISTING: | | PLANNING SCHEME. | |
| RECOMMENDED CONTROL: | | PLANNING SCHEME. | |
| OBSCURED. | SURVEY: RP | DATE: 29.3.1997 | NEGS: 10.12 & 1281.5,6&11 |



246

VIRGINIA STREET

No 8

(245)

No 10.

No 12

(248)

ARBOUR

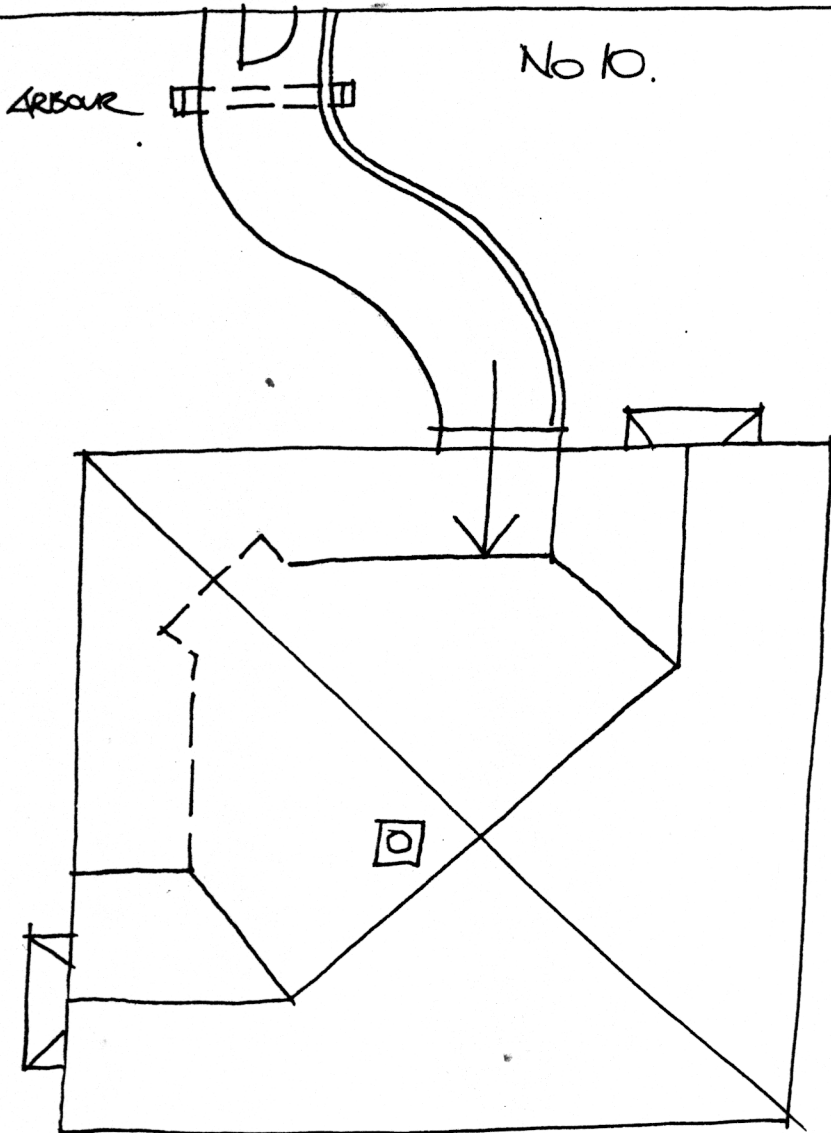

RP. 29.3.97 NTS.

HISTORY: Arthur Madey owned fenced land measuring 45' in 1916 and built a timber house on the following year. He sold it to William Barnet, a clerk, the same year. Barnet was still living there in 1925.¹

VISUAL DESCRIPTION: A triple-fronted almost square timber Edwardian house with a high-hipped roof. The left and rear right side bays are set forward as gables. Upper gables are timbered and jetty on convex timber brackets. Below are mock shingles, timbered over a mould. There are ripple-iron hipped window hoods on large ogee fretwork brackets.

Windows are pairs. The verandah returns around the angle under the hip at right break-pitch. At the angle on splay is a three-sash rectangular bay window. The verandah has plain posts with very unusual Art Nouveau fretwork brackets. The entrance has side and fan-lights. The plain brick chimney has a top mould and a tall terracotta pot. There is a metal pipe arbour at the pedestrian gate with climbing roses, contemporary with the house and brick edging to the serpentine path.

SIGNIFICANCE: A characteristic triple-fronted timber Edwardian house with interesting details such as the verandah brackets and contextual elements such as the arbour, built in 1917. It is architecturally significant locally as representative of this variant of an Edwardian house, and historically in embodying life in Newtown during the Great War and as evidence of the continuing building industry in this period.

INTACTNESS: Very good. The verandah floor has been replaced with a concrete slab and the fence is not appropriate.

CONDITIONS & THREATS: Good.

¹ City of Newtown and Chilwell Ratebooks.