

NEWTOWN URBAN CONSERVATION STUDY. - 'C' CITATIONS. Ref: 265
 Richard Peterson Architect & Conservation Consultant. 1997.

NAME:	Laurel		
FORMER NAME:	Laurell		
ADDRESS:	47 Virginia Street		
USE:	House		
SIGNIFICANT DATE:	CONSTRUCTION DATE:	1914	SOURCE: 1
DESIGNER: —	BUILDER: —		
CRITERIA: H1; Ar1	HISTORIC THEME: 2.3		
DESCRIPTION:	STYLE: Edwardian	STORIES: 2	DETACHED.
MATERIALS:	WALLS Brick	ROOF Slate	STRUCTURE Lb
CONDITION: Good [^]	INTACTNESS: Very good	THREATS: —	
SIGNIFICANT INTACT ELEMENTS:			
MATERIALS. Slate. FORM. FACADE. VERANDAH. ROOF FORM. ROOF DECORATION. CHIMNEYS. Pots. DOOR. PAINTWORK SCHEME. NAMEPLATE. FENCES. GATES. TREE. Magnolia.			
SIGNIFICANCE:			
TYPE:	HISTORICAL. ARCHITECTURAL.		
LEVEL:	LOCAL.		
DESIGNATION EXISTING:	PLANNING SCHEME.		
RECOMMENDED CONTROL:	PLANNING SCHEME.		
SURVEY: RP		DATE: 30.3.1997	NEGS: 10.35; 11.1,2; 1281. 29 & 30.





↑
AUGUST 1997
AFTER REPAINTING.

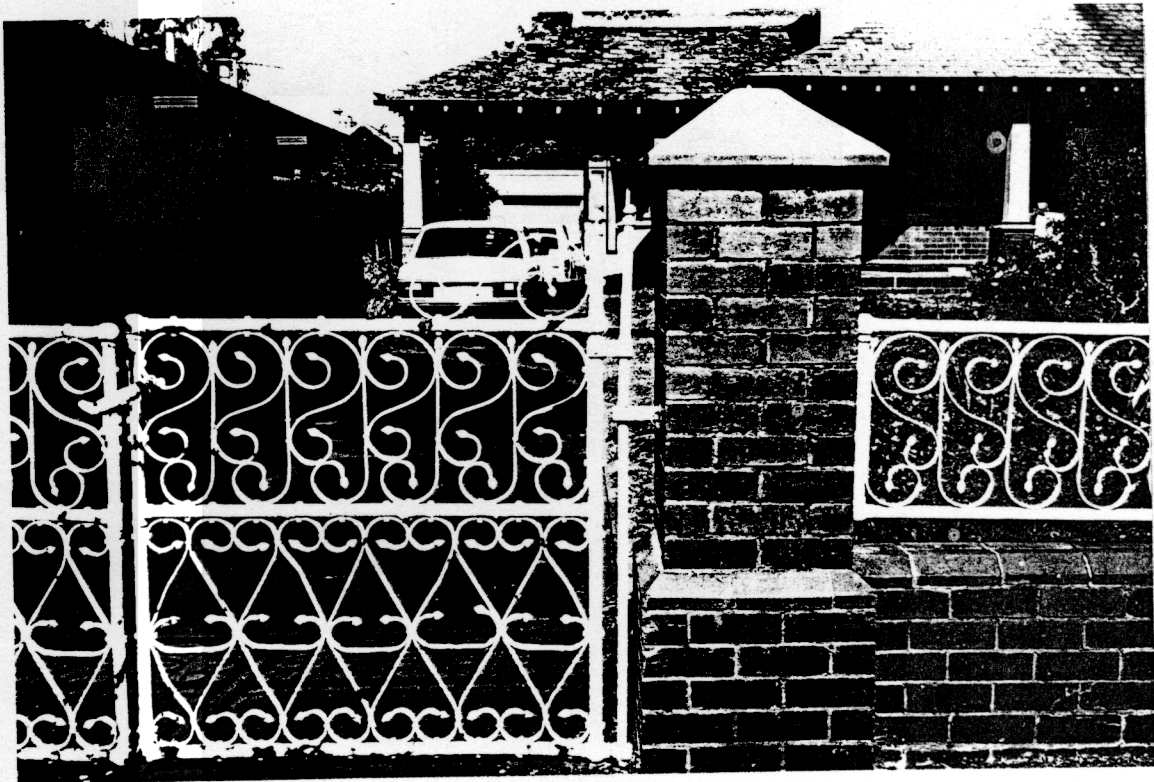

265

VIRGINIA STREET

(267)
No 49

LAUREL
No 47

No
45

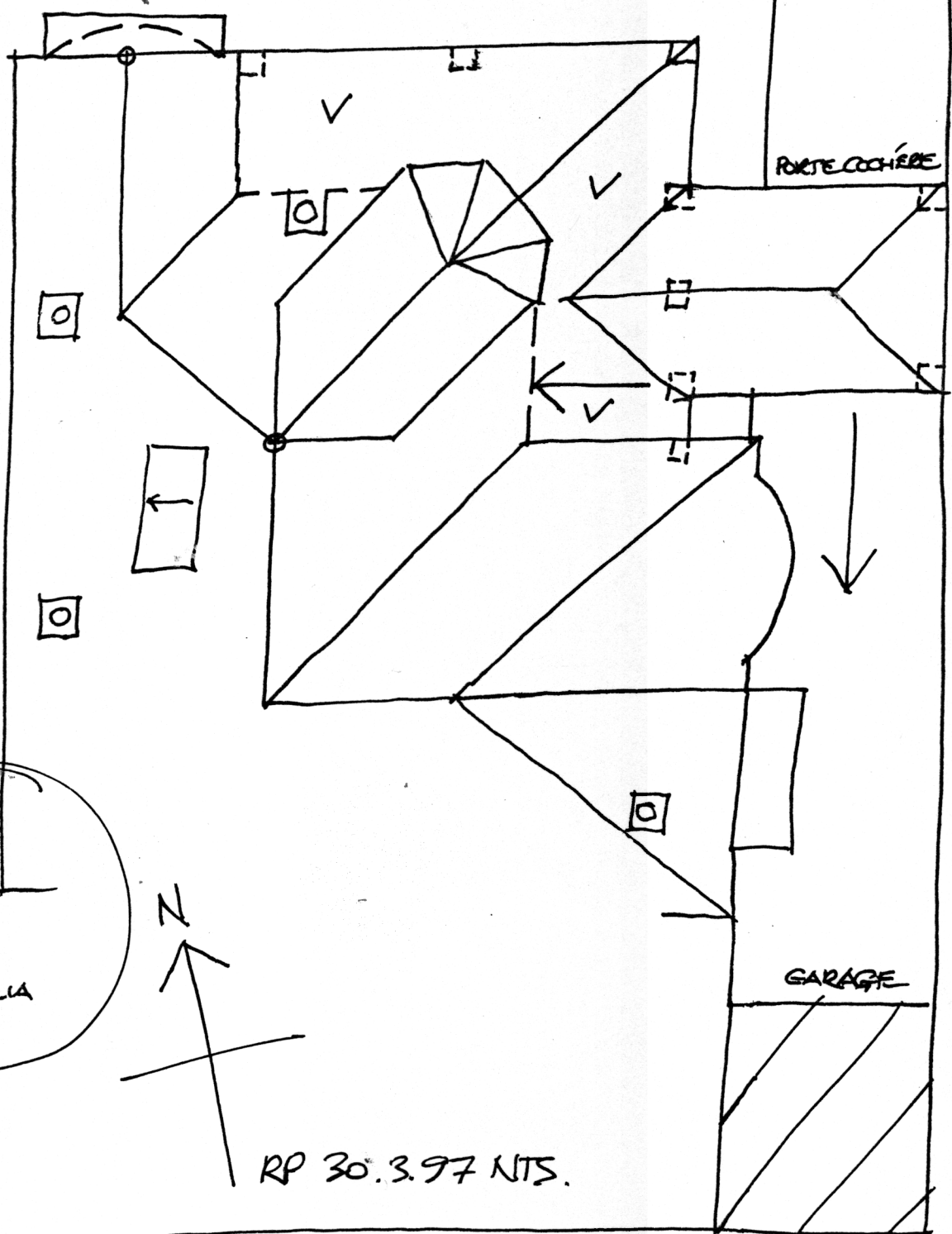

MAGNOLIA
TREE.

N

RP 30.3.97 NTS.

GARAGE

PORTE COCHÈRE

HISTORY: In 1914 Stephen Wrathall, a printer, had a brick house built on this land measuring 60' and called it Laurell. He was still the owner and occupier in 1925 when the land was measured at 60' x 230'.¹

VISUAL DESCRIPTION: A large, L-shaped red brick Edwardian hipped roof house with an attic. The right front bay is set forward as a gable forming a third front. The verandah is under the hip around the angle. At the angle is an octagonal bay. The gable and the side hip have shallow bow windows of five sashes with flat hoods. The gable has a rectangular vent and a relief nameplate.

The verandah is supported on square Tuscan columns on brick plinths with plate moulds. It is geometric encaustic tile-paved with bluestone edging. Walls have a dado band. Rafters are expressed. There is unglazed terracotta cresting and curlicue finials, with a dragon finial at the attic. This is an octagonal bay window on the diagonal. Presumably it would have been an open balcony. It has ogee fretwork brackets. Chimneys are rendered pylons, with terracotta pots.

At right is a rare *porte cochère*. The fence is brick with curlicue metal ribbon and metal pipe framed, over brick piers, with pyramidal caps. There are pedestrian and vehicular metal gates. At rear is a large Magnolia (*Magnolia grandiflora*) tree.

SIGNIFICANCE: A large complex brick Edwardian house with an attic, built in 1914. It has architectural significance locally as a substantial representative of this domestic style. The *porte cochère* is rare. It has historical significance in embodying the family life of an industrialist in the confident years, immediately prior to the Great War.

INTACTNESS: Very good.

CONDITIONS & THREATS: Good.

¹ City of Newtown and Chilwell Ratebooks.