

**NEWTOWN URBAN CONSERVATION STUDY. - 'C' CITATIONS. Ref: 253**  
 Richard Peterson Architect & Conservation Consultant. 1997.

<b>NAME:</b> —			
<b>FORMER NAME:</b> Dorset			
<b>ADDRESS:</b> 17 Virginia Street			
<b>USE:</b> House			
<b>SIGNIFICANT DATE:</b>		<b>CONSTRUCTION DATE:</b> 1879-84	
<b>ALTERATIONS/ADDIT'NS.</b>		<b>DATE:</b> c1970s	
<b>DESIGNER:</b> —		<b>BUILDER:</b> —	
<b>CRITERIA:</b> H1; Ar1		<b>HISTORIC THEME:</b> 2.3	
<b>DESCRIPTION:</b>	<b>STYLE:</b> Edwardian	<b>STORIES:</b> 1	<b>DETACHED.</b>
<b>MATERIALS:</b>	<b>WALLS:</b> Timber	<b>ROOF:</b> Iron	<b>STRUCTURE:</b> Stud
<b>CONDITION:</b> Fair	<b>INTACTNESS:</b> Very good	<b>THREATS:</b> Maintenance	
<b>SIGNIFICANT INTACT ELEMENTS:</b>			
MATERIALS. Pressed metal roofing. FORM. FACADE. VERANDAH. ROOF FORM. GABLE DECORATION. EAVES DECORATION. ROOF DECORATION. Finial. VERANDAH DECORATION. CHIMNEYS. Pots. DOOR. WINDOWS.			
<b>SIGNIFICANCE:</b>			
<b>TYPE:</b>	HISTORICAL. ARCHITECTURAL.		
<b>LEVEL:</b>	LOCAL.		
<b>DESIGNATION EXISTING:</b>	PLANNING SCHEME.		
<b>RECOMMENDED CONTROL:</b>	PLANNING SCHEME.		
<b>SURVEY:</b> RP		<b>DATE:</b> 29.3.1997	<b>NEGS:</b> 10.19 & 1281.15

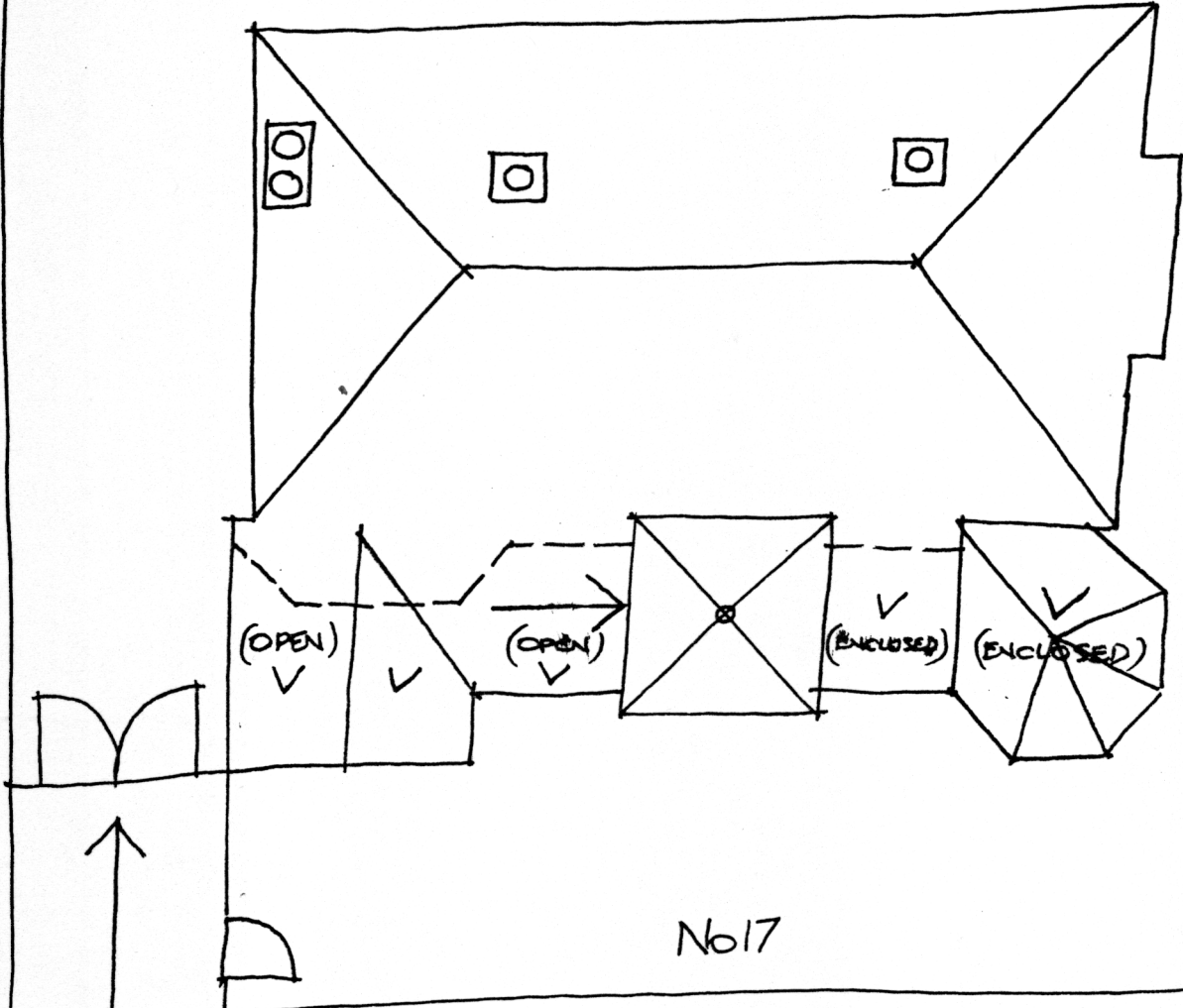

253



(251)  
No 15

No 17

No 21

VIRGINIA STREET

RP. 29.3.97 NTS

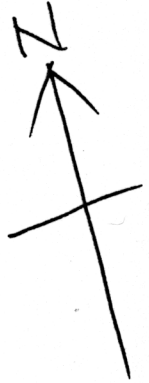

*Richard Peterson Architect & Conservation Consultant 1997.*

**HISTORY:** Prior to 1879 a large part of Virginia Street was land owned by John Donohoe or William Purnell. The rate books are missing for the following few years but in 1884 this block, owned and occupied by George Strong, boot manufacturer, measured 60' and had a seven room timber building on it. In 1890, while Strong still owned the house, it was described as having 6 rooms and only 50' of land. Five years later he had built another three rooms. Strong was still listed as living in, and owning the house in 1925. Around the turn of the century he named it 'Dorset'. C1910 the house was described as having 9 rooms and stables, although a few years later, in 1915, it had only 7 rooms and in 1925 the land was measured at 60' x 229'.<sup>1</sup>

**VISUAL DESCRIPTION:** A complex five-bay apparently Edwardian timber house, with a hipped roof, the left bay set forward as a gable. The upper gable jettys on ogee brackets, timbered roughcast pattern pressed metal, the barges shaped. Below is the verandah, which extends across the front past a canted bay at left in interrupted centre, by a square tower. The valance is lattice, on sinuous fretwork brackets at left and second bay. The tower's weatherboards are beaded. Its upper section is similar to the gable, with cornice mould, with a high pyramidal roof clad with unusual pressed metal in scales pattern and ridges with a fine pressed metal finial.

At right is an octagonal belvedere, now enclosed. Upper window sashes are leadlight. The flyscreen door may be original. Chimneys have Classical moulds and glazed terracotta pots. At left the eaves have a shield-shaped valance, on ogee brackets and panels between.

**COMPARATIVE ANALYSIS:** The shield motif occurs also at No. 20 (254). Quite possibly. Prior to alteration, this house once resembled no. 20.

**SIGNIFICANCE:** A complex timber Edwardian house, with an extensive and complex verandah and unusual roofing elements, built in 1884, but with major alterations from c1900, by a new owner. It is architecturally significant as an unusual, complex Edwardian house (in external appearance now, at least), and historically in embodying the development of a family house with changing ownership and (generally) professional family life in Newtown in the mid 1880s and early this century.

**INTACTNESS:** Very good. The right verandah is infilled at the high fence and gates are not appropriate either.

**CONDITIONS & THREATS:** Fair.

---

<sup>1</sup> City of Newtown and Chilwell Ratebooks.