

NEWTOWN URBAN CONSERVATION STUDY. - 'C' CITATIONS. Ref: 212

Richard Peterson Architect & Conservation Consultant. 1997.

NAME: —		
ADDRESS: 46 Skene Street.		
USE: House		
SIGNIFICANT DATE:	CONSTRUCTION DATE: 1913	SOURCE: 1
ADDITIONS:	DATE: c1970	SOURCE: Visual
DESIGNER: —	BUILDER:	
CRITERIA: H1; Ar1	HISTORIC THEME: 2.3	
DESCRIPTION:	STYLE: Edwardian	STORIES: 1
MATERIALS:	WALLS: Timber	ROOF: Zincalume
CONDITION: Very good	INTACTNESS: Very good	THREATS: Sale
SIGNIFICANT INTACT ELEMENTS: FORM. FACADE. VERANDAH. ROOF FORM. GABLE DECORATION. ROOF DECORATION. VERANDAH DECORATION. CHIMNEYS. DOOR. WINDOWS. CONTEXT Nos: 48 & 50..		
SIGNIFICANCE:		
TYPE:	HISTORICAL. ARCHITECTURAL.	
LEVEL:	LOCAL.	
DESIGNATION EXISTING:	PLANNING SCHEME.	
RECOMMENDED CONTROL:	PLANNING SCHEME.	
SURVEY: RP		
DATE: 27.3.1997		
NEGS: 9.3 & 1280.3		



212

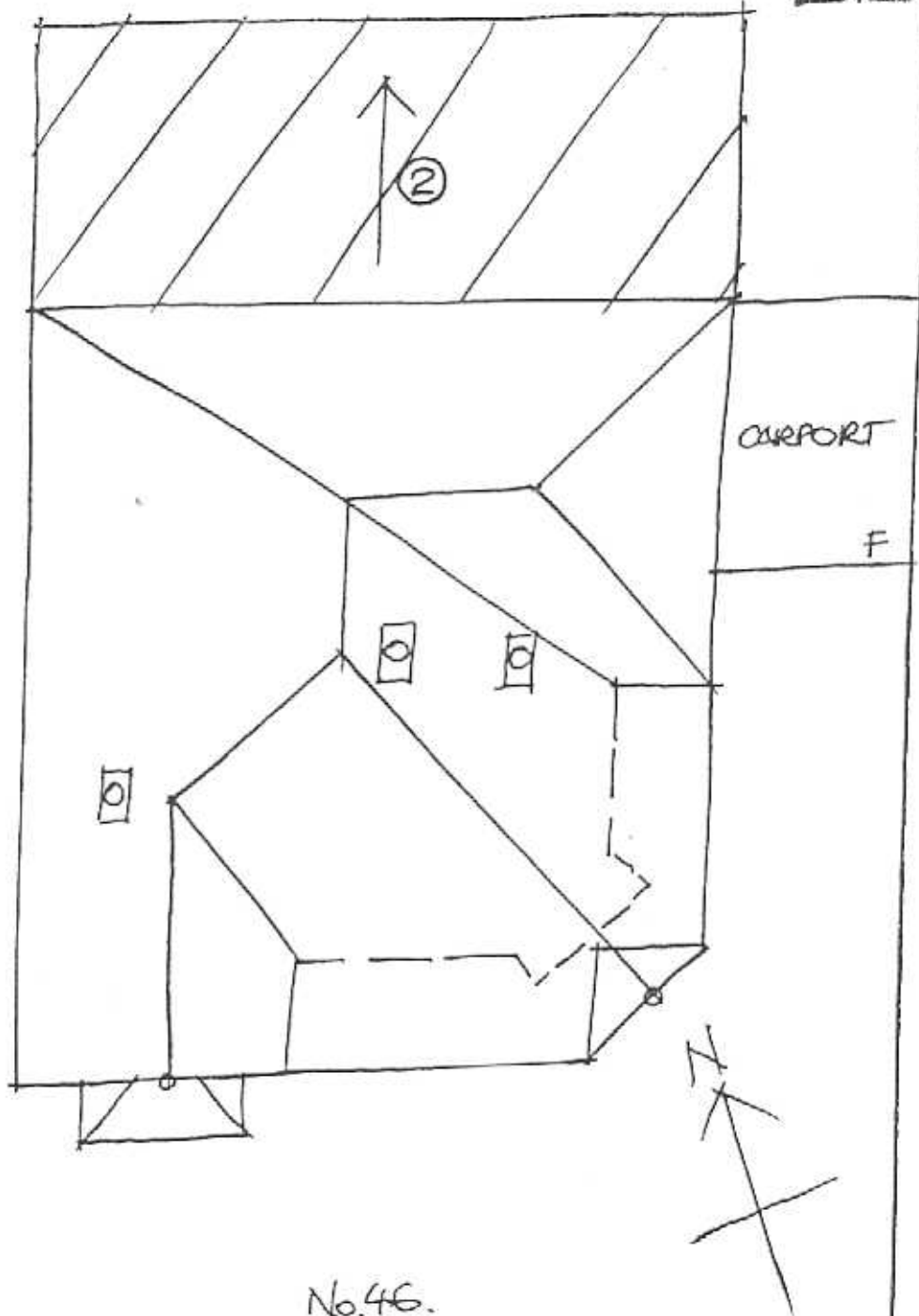

(213)

No 48

No. 46.

SKENE STREET

RECENT: 

RP. 27.3.97 NTS.

HISTORY: Owned by John and Caroline Brown, storeman and housewife, this timber house was built in 1913 on land measuring 47' x 162'8". In the early 1920s the Browns sold the house to Elizabeth & Charles Eastwood who lived in it for a few years before selling to John Rutherford. Rutherford rented the house, but in 1931 he sold it back to the Eastwood Estate who continued to own it in 1935, but rented it to Charles Walsh, foreman.¹

VISUAL DESCRIPTION: A triple-fronted timber Edwardian hipped roof house. The left bay is set forward as a gable and right rear side bay also projects. The verandah returns with a rectangular bay and a gable on the splay at the angle. Its valence is palisade, with tulip fretwork pairs and catenary-curved at the splay and side rear. Brackets are fretwork, posts have an unusual flush bead.

The left window has a large hipped hood on four elaborate fretwork tulip ogce brackets. It is a triple sash and projects on ogce brackets. There are two small segmental head leadlight windows under the verandah. Gables have pressed metal curlicue finials. Chimneys have a frieze and corbelled tops with terracotta pots. Upper gables are timbered, with pressed metal roughcast pattern.

SIGNIFICANCE: A characteristic Edwardian timber house built in 1913 for working class owners. It is architecturally significant locally as representative of this domestic style and historically as embodying comfortable working class family life in the prosperous years immediately prior to the Great War in Newtown.

INTACTNESS: Very good.

CONDITIONS & THREATS: Very good.

¹ City of Newtown and Chilwell Ratebooks.