

NEWTOWN URBAN CONSERVATION STUDY. - 'C' CITATIONS. Ref: 239
 Richard Peterson Architect & Conservation Consultant. 1997.

NAME: —	
ADDRESS: 171 Skene Street	
USE: House	CONSTRUCTION DATE: 1910 SOURCE: 1
SIGNIFICANT DATE: —	BUILDER: —
DESIGNER: —	HISTORIC THEME: 2.3
CRITERIA: H1; Ar1	
DESCRIPTION: STYLE: Edwardian STORIES: 1 DETACHED.	
MATERIALS: WALLS Timber ROOF Iron STRUCTURE Stud	
CONDITION: Good INTACTNESS: Very good THREATS: Renovation?	
SIGNIFICANT INTACT ELEMENTS: FORM. FACADE. VERANDAH. ROOF FORM. GABLE DECORATION. EAVES DECORATION. Brackets. ROOF DECORATION. VERANDAH DECORATION. CHIMNEYS. Pots. DOOR. WINDOWS. FENCE. GATES. CONTEXT No: 169.	
SIGNIFICANCE:	
TYPE:	HISTORICAL. ARCHITECTURAL.
LEVEL:	LOCAL.
DESIGNATION EXISTING:	PLANNING SCHEME.
RECOMMENDED CONTROL:	PLANNING SCHEME.
SURVEY: RP	DATE: 29.3.1997 NEGS: 10.1 & 1280.32

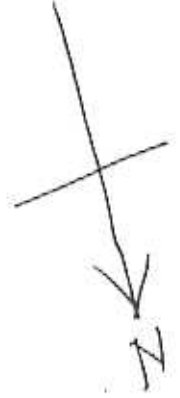

239.

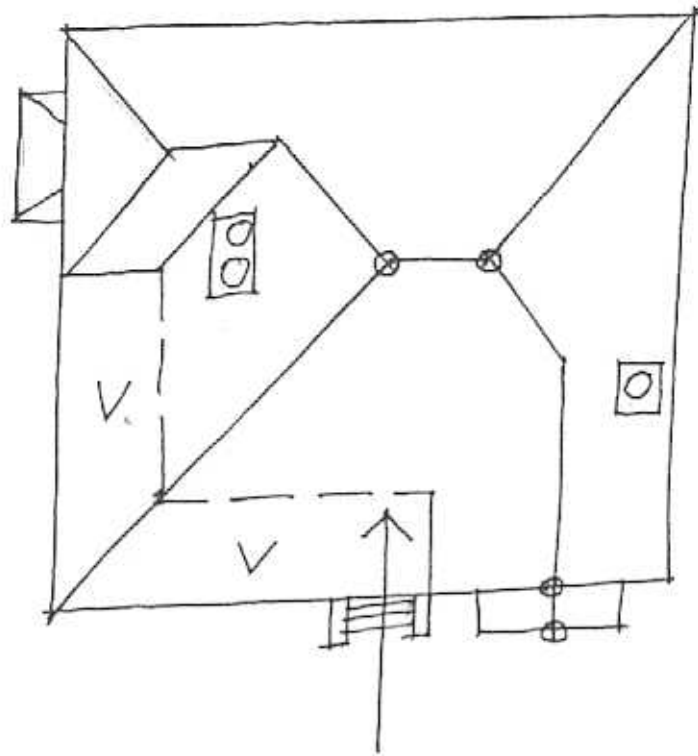

(238)
No 169

No 171

(240)
No 173
ST HEUER

SKENE STREET

RP.

Richard Peterson Architect & Conservation Consultant 1997.

HISTORY: This house was built for Arthur Bonney in 1910. Perhaps Bonney died shortly after the house was constructed, or maybe he built the house for a relative because until 1930 it was occupied by Caroline Bonney who was described as a 'widow'.¹

VISUAL DESCRIPTION: A triple-fronted timber Edwardian house, with a high-hipped roof and some Asian influences. The left side rear bay is set forward; as is the front right bay as a gable. This has its central section set further forward, as an inglenook, with a minor gable. Upper gables have pressed metal roughcast (upper), or lozenge (lower) pattern. This latter continues across the main gable as a frieze. The use of patterned pressed metal externally is unusual in Newtown. Barge ends are shaped.

Rafters are exposed and most unusually, supported by fretwork brackets. Ridges have sheet metal curlicue finials and crenellated cresting. The verandah extends around the angle under the hip, slightly break-pitch. This has a palisade valance over a rail, with arches front, at ends, next to post-pairs. The valance is alternately straight and wavy, with fretwork tulip pair panels. Brackets are bold coved fretwork.

Chimneys are plain brick, with top mould and terracotta pots. Windows are pairs and there is a diamond-shaped window at the left end of the verandah. The entrance has side and fanlights.

SIGNIFICANCE: A timber Edwardian house with some Asian influences, built in 1910. It has architectural significance locally as representative of this domestic style and its eclectic decorative sources and historically in embodying life in Newtown early this century.

INTACTNESS: Very good.

CONDITIONS & THREATS: Good. Being renovated. It has been restumped², and the verandah floor appropriately replaced with hardwood.

¹ City of Newtown and Chilwell Rate Books

² The owners in conversation with RP, 29 March 1997.