

**NEWTOWN URBAN CONSERVATION STUDY. - 'C' CITATIONS. Ref: 230**

Richard Peterson Architect & Conservation Consultant. 1997.

<b>NAME:</b> —	
<b>ADDRESS:</b> 145 Skene Street (SE cnr George Street)	
<b>USE:</b> House	
<b>SIGNIFICANT DATE:</b>	<b>CONSTRUCTION DATE:</b> c1925 <b>SOURCE:</b> Visual
<b>ALTERATIONS/ADDITIONS.</b>	<b>DATE:</b> 1990s <b>SOURCE:</b> Visual
<b>DESIGNER:</b> —	<b>BUILDER:</b>
<b>CRITERIA:</b> H1; Ar1	<b>HISTORIC THEME:</b> 2.3
<b>DESCRIPTION:</b>	<b>STYLE:</b> Bungalow <b>STORIES:</b> 2 <b>DETACHED.</b>
<b>MATERIALS:</b>	<b>WALLS:</b> Timber <b>ROOF:</b> <b>STRUCTURE:</b>
<b>CONDITION:</b> Excellent	<b>INTACTNESS:</b> Fair <b>THREATS:</b> Over development.
<b>SIGNIFICANT INTACT ELEMENTS:</b>	
FORM. FACADE. GABLE DECORATION. DOOR. WINDOWS .	
<b>SIGNIFICANCE:</b>	
<b>TYPE:</b>	HISTORICAL. ARCHITECTURAL.
<b>LEVEL:</b>	LOCAL.
<b>DESIGNATION EXISTING:</b>	PLANNING SCHEME.
<b>RECOMMENDED CONTROL:</b>	PLANNING SCHEME.
SURVEY: RP DATE: 28.3.1997 NEGS: 9.25 & 1280.21	



230

SKENE STREET

No 145

No 143

228

GEORGE STREET

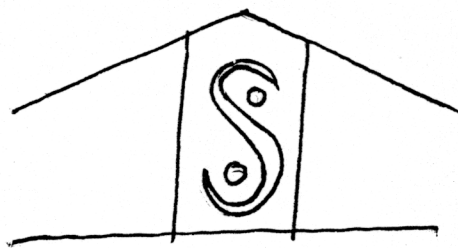
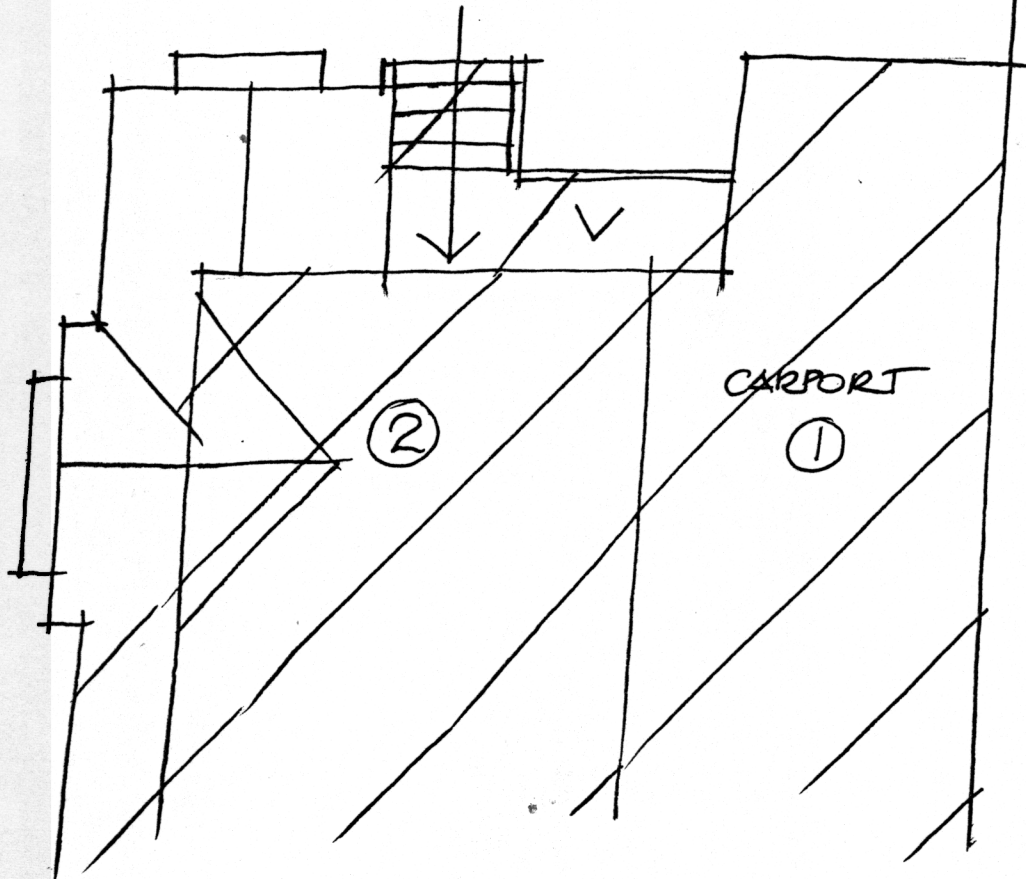

RP 28.3.97 NTS.

RECENT ADDITION

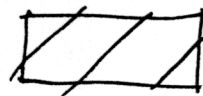

**HISTORY:** (This was not possible to research).

**VISUAL DESCRIPTION:** A double-fronted timber Californian Bungalow with gables projecting at front right and right side, with a verandah in the angle at left. Upper gables have palisade vents, with an unusual S-motif (original?), over shingles jettied on triple-bullnosed brackets.

At front right is a rectangular bay tripartite window, with a flat roof on deep ogee brackets, (possibly not original). There is a similar hood at right side. Upper sashes are leadlight. The entrance door is panelled and glazed with leadlight as is the sidelight.

**SIGNIFICANCE:** A characteristic timber Californian Bungalow, whose significance has been greatly compromised by massive additions and alteration, sometimes in a confusingly historicist manner. It remains architecturally significant locally as representative of this domestic style and historically in embodying life in Newtown between the wars.

**INTACTNESS:** Fair only. There is a very major, perhaps overwhelming, double-storey development which has drastically altered the form. The verandah appears to be rebuilt, with a new flyscreen door, new balustrade, new chimneys, new fence, new carport etc.

**CONDITION:** Excellent.