

NEWTOWN URBAN CONSERVATION STUDY. - 'C' CITATIONS. Ref: 224

Richard Peterson Architect & Conservation Consultant. 1997.

NAME: —			
ADDRESS: 133 Skene Street			
USE: House			
SIGNIFICANT DATE:	CONSTRUCTION DATE: 1921	SOURCE: 1	
ADDITIONS:	DATE: 1990s.(?)	SOURCE: Visual	
DESIGNER: —	BUILDER: —		
CRITERIA: H1; Ar1	HISTORIC THEME: 2.3		
DESCRIPTION:	STYLE: Edwardian	STORIES: 1	DETACHED. To boundaries
MATERIALS:	WALLS: Timber	ROOF: Iron	STRUCTURE: Stud
CONDITION: Very good	INTACTNESS: Very good		THREATS: —
SIGNIFICANT INTACT ELEMENTS:			
FORM. FACADE. VERANDAH. ROOF FORM. GABLE DECORATION. VERANDAH DECORATION. CHIMNEY. Pots. DOOR. WINDOWS. CONTEXT No: 131.			
SIGNIFICANCE:			
TYPE:	HISTORICAL. ARCHITECTURAL.		
LEVEL:	LOCAL.		
DESIGNATION EXISTING:	PLANNING SCHEME.		
RECOMMENDED CONTROL:	PLANNING SCHEME.		
SURVEY: RP DATE: 28.3.1997 NEGS: 9.16 & 1280.15			



SKENE STREET

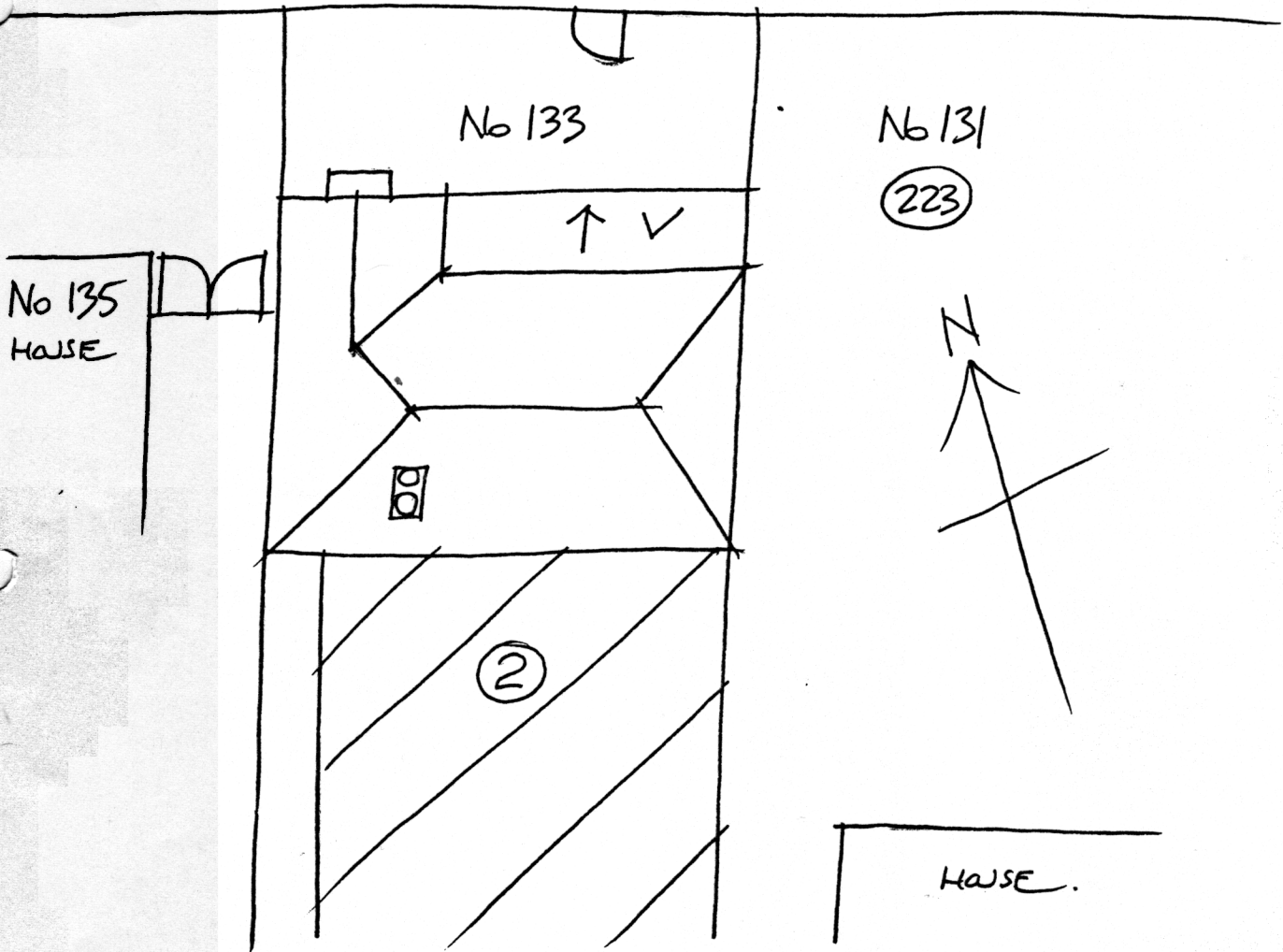

RP. 28.3.97 NTS.
DOUBLE STOREY ADDITION:

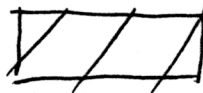

Richard Peterson Architect & Conservation Consultant 1997.

HISTORY: This house was built for a tailor, Herbert Finnigan, in 1921. By 1925 Finnigan had sold to Robert Deane, a foreman, who subsequently sold to John Quinn who, in 1930, rented the property to a labourer, John Tucker.

VISUAL DESCRIPTION: A double-fronted Edwardian house with a hipped roof. The right bay is set forward as a gable. Its upper section jettys on ogee brackets between panels as the frieze, over a mould. Its central section bellies forward, timbered roughcast, with its own barge, set further forward. Barge ends are ogee shaped. The window has a ripple-iron skillion hood on palisade over fretwork fleur-de-lis brackets. It has a casement pair with leadlight highlights. The chimney has terracotta pots. The bullnosed verandah is in the angle, with a deeply haunched and arched valance with ying and yang fretwork. The entrance door is glazed and panelled with a highlight.

SIGNIFICANCE: A characteristic timber Edwardian house built in 1921 with some exotic decorative motifs. It is architecturally significant locally as representative of this domestic style and historically in embodying artisan life in 1920s Newtown.

INTACTNESS: Very good. Fence, balustrade, flyscreen door and verandah floor are recent. There is a major double-storey addition at rear.

CONDITIONS & THREATS: Very good.