

NEWTOWN URBAN CONSERVATION STUDY. - 'C' CITATIONS. Ref: 169
 Richard Peterson Architect & Conservation Consultant. 1997.

NAME: —			
ADDRESS: 43 Retreat Road			
USE: House			
SIGNIFICANT DATE:	CONSTRUCTION DATE: 1908	SOURCE: 1	
DESIGNER: —	BUILDER: —		
CRITERIA: H1, Ar1	HISTORIC THEME: 2.3		
DESCRIPTION:	STYLE: Edwardian	STORIES: 1	DETACHED.
MATERIALS:	WALLS: Timber	ROOF: Iron	STRUCTURE: Stud
CONDITION: Excellent	INTACTNESS: Very good	THREATS: —	
SIGNIFICANT INTACT ELEMENTS:			
FORM. FACADE. VERANDAH. ROOF FORM. GABLE DECORATION. VERANDAH DECORATION. CHIMNEY. DOOR. WINDOWS. CONTEXT No: 35,37,45,47,49,51,53,55			
SIGNIFICANCE:			
TYPE:	HISTORICAL. ARCHITECTURAL.		
LEVEL:	LOCAL.		
DESIGNATION EXISTING:	PLANNING SCHEME.		
RECOMMENDED CONTROL:	PLANNING SCHEME.		
OBSCURED.	SURVEY: RP	DATE: 9.2.1997	NEGS: 8.10 & 1275.18



REAR ROAD

No 43

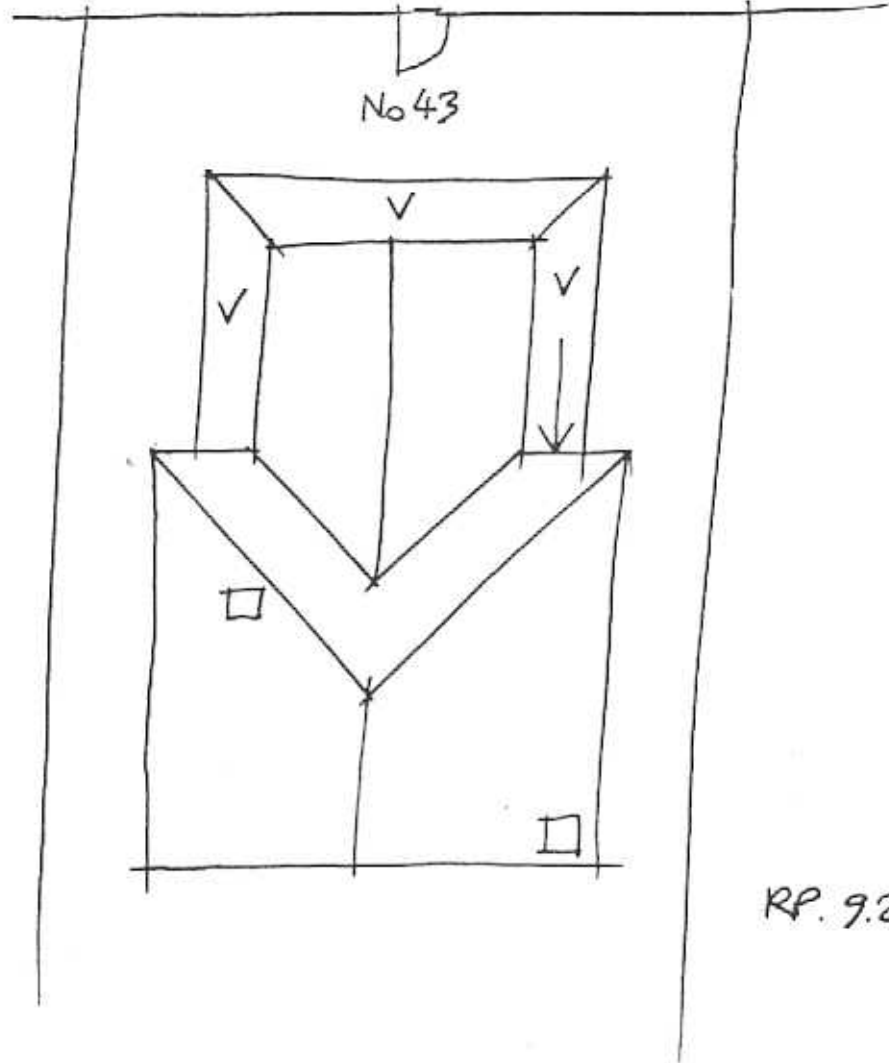

RP. 9.2.97 NTS.

HISTORY: In 1908 William Timin, stationer, was the owner and occupier of this property while it was in construction. He sold it two years later as a timber cottage with six rooms to David Philpott, traveller. Philpott continued to live in the house for about ten years and sold it in the early 1920s to Douglas Tucker, clerk. Throughout the 1920s and 1930s the property was described as a house on land measuring 40' x 122'.¹

VISUAL DESCRIPTION: A simple double-bay Edwardian timber, hip-roofed house, with a central gable projecting. The verandah returns at both sides. The upper gable has Medievalising timbers over ripple-iron. Windows are singles with architraves and a decorative apron in fretwork.

The verandah has a Chinoiserie lattice valance and posts have vertical and horizontal decorative grooves incised. Chimneys are red brick with render frieze.

SIGNIFICANCE: A simple double-bay Edwardian timber house built in 1908. It is architecturally significant locally as characteristic of this style yet with exotic elements such as Medieval and Chinoiserie. The simple gable anticipates the Bungalow style of the 1920s.

INTACTNESS: Very good. The fence is anachronistic.

CONDITIONS & THREATS: Excellent.

¹ City of Newtown and Chilwell Ratebooks.