

**NEWTOWN URBAN CONSERVATION STUDY. - 'C' CITATIONS.** Ref: 157  
 Richard Peterson Architect & Conservation Consultant. 1997.

<b>NAME:</b> —		
<b>ADDRESS:</b> 1 Raglan Street		
<b>USE:</b> House		
<b>SIGNIFICANT DATE:</b>	<b>CONSTRUCTION DATE:</b> 1921(?)	<b>SOURCE:</b> 1
<b>ALTERATIONS/ADDITIONS.</b>	<b>DATE:</b> ?	<b>SOURCE:</b> Visual
<b>DESIGNER:</b> —		<b>BUILDER:</b> —
<b>CRITERIA:</b> HI; Ar1.		<b>HISTORIC THEME:</b> 2.3
<b>DESCRIPTION:</b>	<b>STYLE:</b> Early	<b>STORIES:</b> 1
<b>MATERIALS:</b>	<b>WALLS:</b> Brick	<b>ROOF:</b> Metal tiles
<b>CONDITION:</b> Good	<b>INTACTNESS:</b> Good	<b>DETACHED.</b> <b>STRUCTURE:</b> Lb.
<b>THREATS:</b> —		
<b>SIGNIFICANT INTACT ELEMENTS:</b>		
MATERIALS. Tuckpointing, brickwork. FORM. FACADE. ROOF FORM. GABLE DECORATION. EAVES DECORATION. CHIMNEYS. WALL DECORATION. WINDOWS. UNPAINTED FINISH.		
<b>SIGNIFICANCE:</b>		
<b>TYPE:</b>	HISTORICAL. ARCHITECTURAL.	
<b>LEVEL:</b>	LOCAL.	
<b>DESIGNATION EXISTING:</b>	PLANNING SCHEME.	
<b>RECOMMENDED CONTROL:</b>	PLANNING SCHEME.	
<b>SURVEY:</b> RP <b>DATE:</b> 9.2.1997 <b>NEGS:</b> 7.27 & 1274.37		

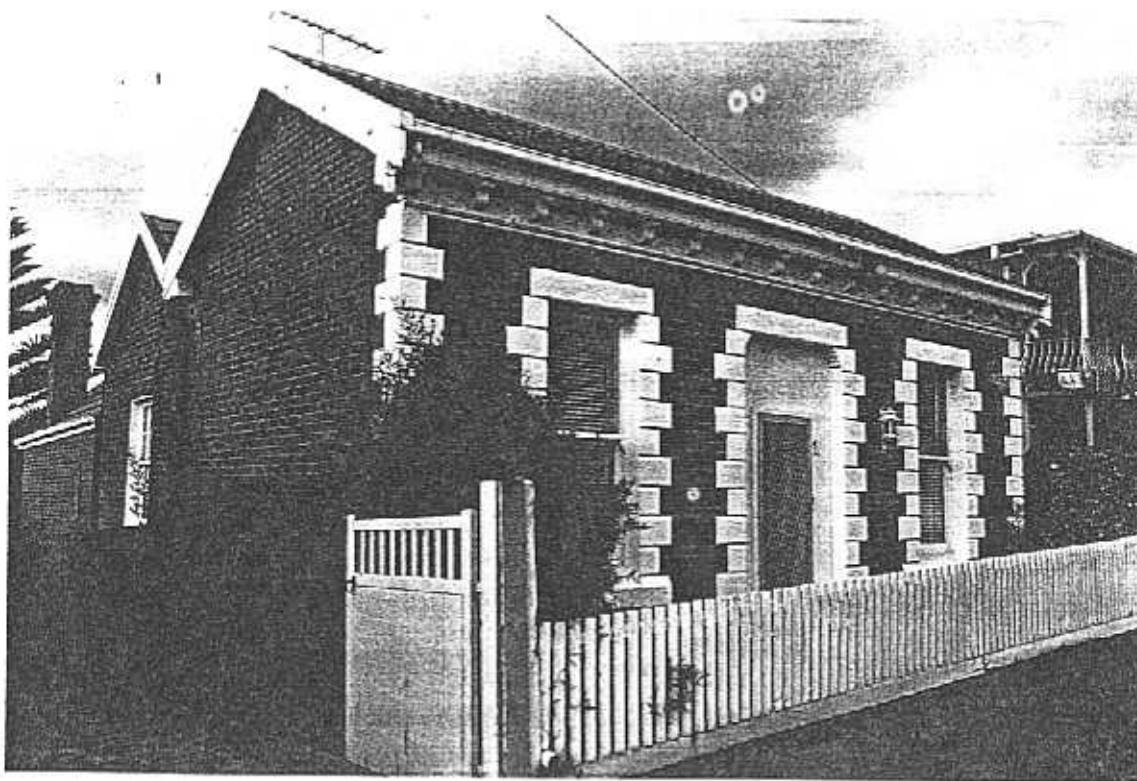

RAGLAN STREET

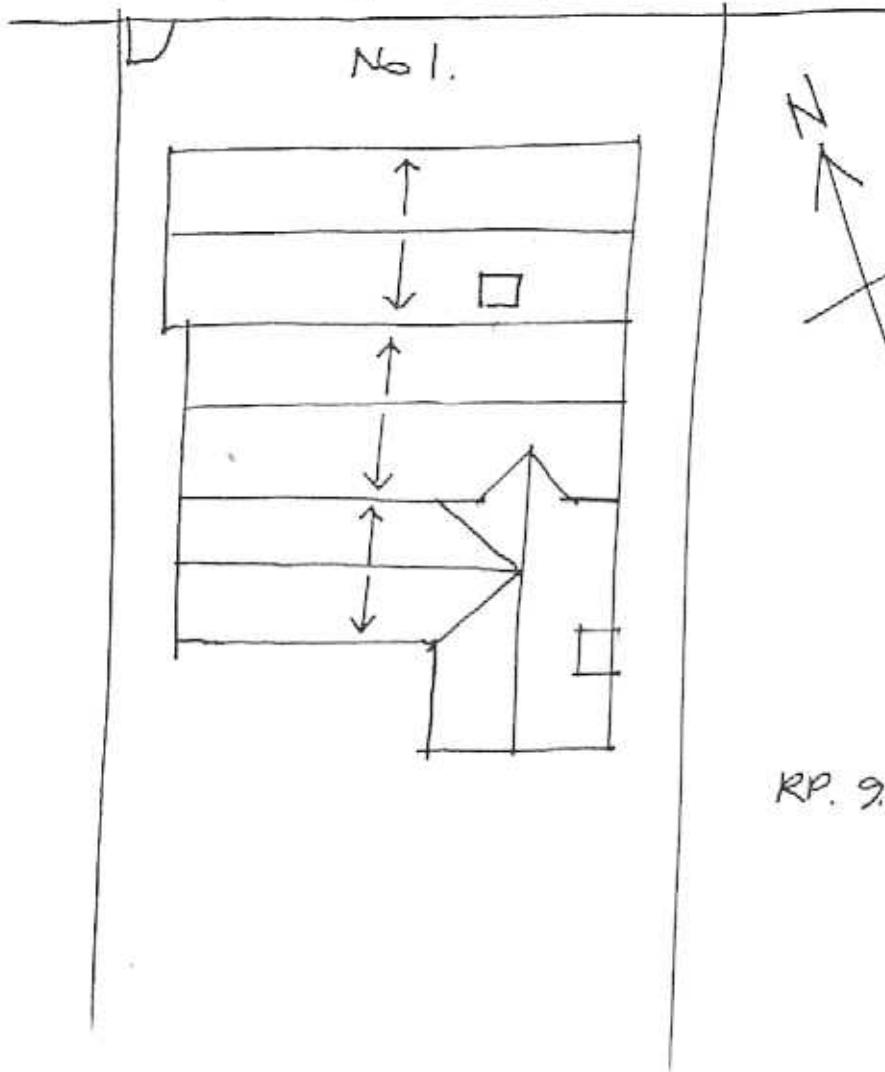

RP. 9.2.97 NTS.

*Richard Peterson Architect & Conservation Consultant 1997.*

**HISTORY:** In 1921 owner James Dew replaced the timber house on the 33' by 100' block with a brick house. Peter Moroney, carter, remained his tenant. The following year Dew sold to Mary Moroney. She remained the owner, with the Moroney family tenating the house, until the late 1930s. Mary Moroney then sold to Nina Smith who kept the house, still tenanted, for nearly twenty years. Her last tenant was the Williams family who bought the house from her in the mid 1950s and remained living in it.<sup>1</sup>

**VISUAL DESCRIPTION:** A symmetrical double-fronted Renaissance revival early brick cottage with a gable-roof across. This has barges incised with quatrefoils. The caves are supported by stubby ogee brackets over a frieze mould. Brickwork is dark brown finely tuckpointed at front. This has sandstone(?) quoins at the openings and corners, lintels and cills.

There is a second gable addition and a third, L-shaped. It has a bluestone base, rockface and finely dressed. The roof is metal tiles.

**SIGNIFICANCE:** A fine Renaissance revival early cottage built in 1867 and with two sympathetic later additions. It is architecturally significant as characteristic of this type of early cottage and historically significant as embodying life in early Newtown.

**INTACTNESS:** Good. It lacks a verandah (perhaps it never had one?). The entrance has been removed and poorly replaced. Barges have been degraded, roofing has been replaced by an inappropriate material. Frieze and quoins have been painted. The latest addition has been brick-clad. A rainwater head on the east side overflows and damages the wall.

**CONDITIONS & THREATS:** Good, but it needs some maintenance.

---

<sup>1</sup> City of Newtown and Chilwell Ratebooks. It is difficult to accept (but not impossible) that this house was built in 1921. It certainly looks earlier.