

NEWTOWN URBAN CONSERVATION STUDY. - 'C' CITATIONS. Ref: 156
 Richard Peterson Architect & Conservation Consultant, 1997.

NAME: —			
ADDRESS: 117 Prospect Road			
USE: House			
SIGNIFICANT DATE:		CONSTRUCTION DATE: c1925	SOURCE: Visual
DESIGNER: —		BUILDER:	
CRITERIA:		HISTORIC THEME:	
DESCRIPTION:	STYLE: Bungalow	STORIES: 1	DETACHED.
MATERIALS:	WALLS Roughcast	ROOF Tiles	STRUCTURE Stud.
CONDITION: Good	INTACTNESS: Very good	THREATS: —	
SIGNIFICANT INTACT ELEMENTS: FORM. FACADE. VERANDAH. ROOF FORM. GABLE DECORATION. VERANDAH DECORATION. CHIMNEY.			
SIGNIFICANCE:			
TYPE:	HISTORICAL. ARCHITECTURAL.		
LEVEL:	LOCAL.		
DESIGNATION EXISTING:		PLANNING SCHEME.	
RECOMMENDED CONTROL:		PLANNING SCHEME.	
OBSCURED.	SURVEY: RP	DATE: 8.2.1997	NEGS: 7.25, 1274,34 & 35



156



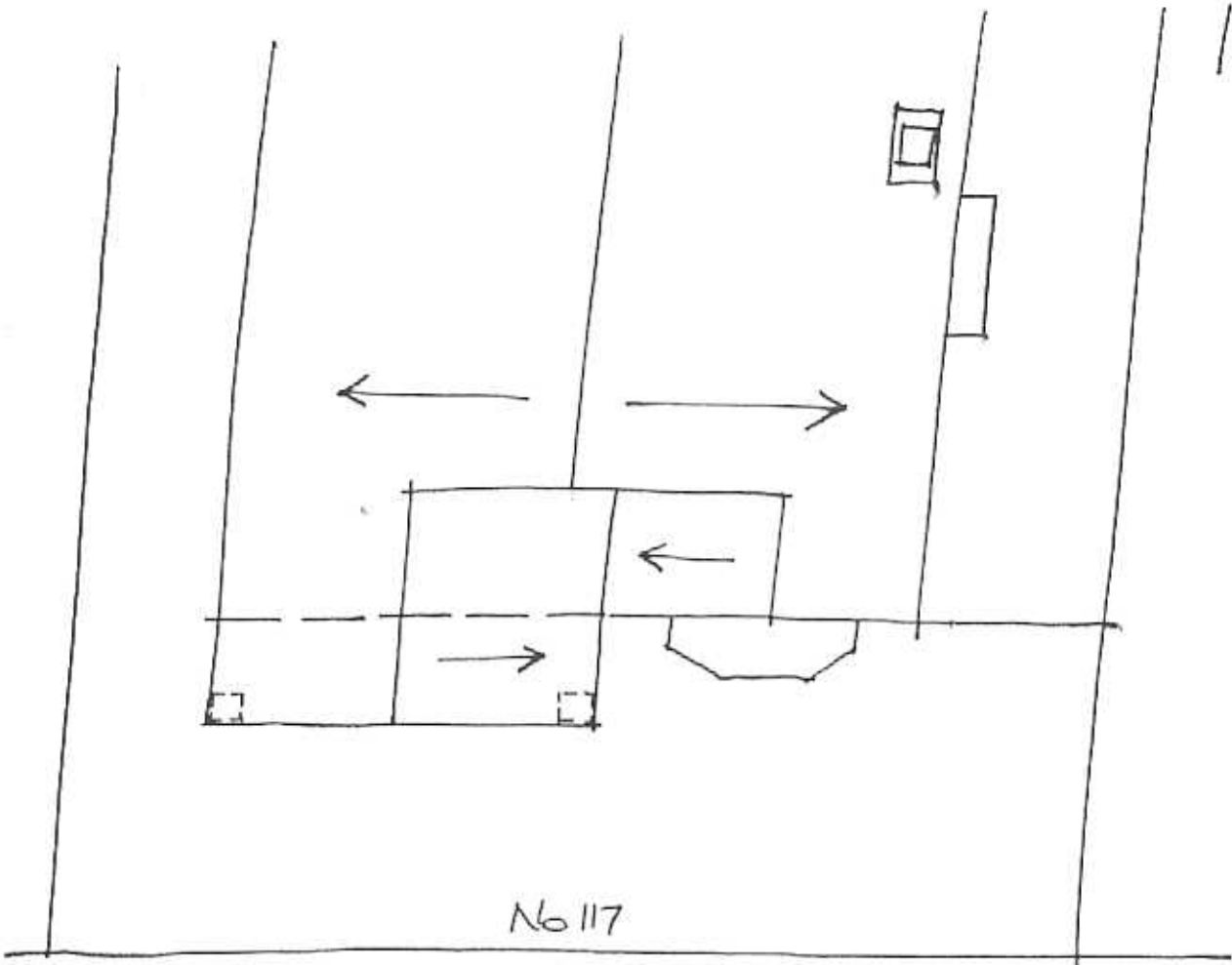

No 117

PROSPECT ROAD RP NTS 8.2.97.

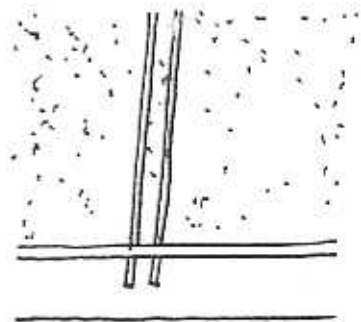
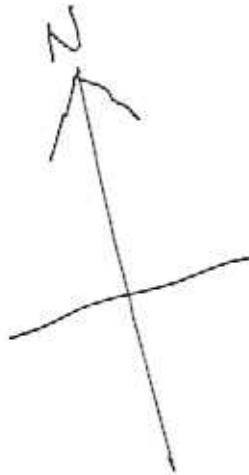

DECORATION.
DETAIL.

Richard Peterson Architect & Conservation Consultant 1997.

HISTORY: The house at 117 Prospect Road was constructed in 1919 for Frank Ritchie. In 1920 it was occupied by Wolf Freedman, although still owned by Ritchie. By 1930 Louisa Dance had purchased the property, although by 1940 she had moved to Commercial Street, Kaniva and it was occupied by Robert Netherall who was described as being an agent. Netherall lived at 117 Prospect Street with two other occupants.¹

VISUAL DESCRIPTION: A double-fronted timber Californian Bungalow with a major and two minor nested gables facing. These have double lathe decoration. The roof has unglazed Marseilles terracotta tiles. Walls are roughcast, excepting a weatherboard dado at front. The left gable is set forward over the verandah. Its upper section is over splayed mock singles, then a shallow catenary-curved bressummer and abstracted square Tuscan piers on roughcast plinths. The right gable is supported on a group of five bullnosed brackets at centre and larger concave brackets at sides. It has a canted oriel, with a flat-roof. Both are supported by deep ogee brackets.

SIGNIFICANCE: An early timber Californian Bungalow, built in 1919. Architecturally locally significant as early and characteristic of the type and historical significance as embodying life in Newtown immediately after the Great War.

INTACTNESS: Very good, but the anachronistic fence and flyscreen door are not appropriate. The balustrade may also be later but is sympathetic. The canted bay window also seems to have been replaced.

CONDITIONS & THREATS: Good. The roof is being repaired.

¹ City of Newtown and Chilwell Rate Books